

FILED
GREENVILLE CO. S. C.
MAR 25 3 48 PM '83
DONNIE S. TANKERSLEY
R.M.C.

HENDERSON EST.

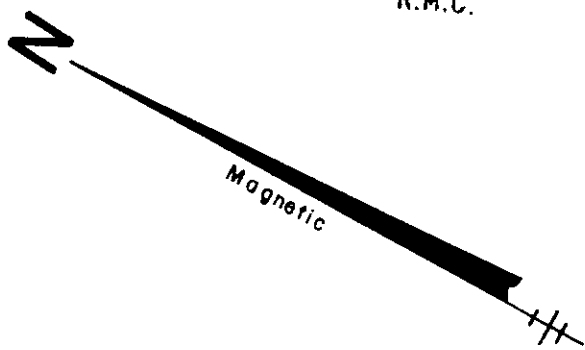

I.P.O. S 28 - 56 E 100.0' I.P.N. 100.0' I.P.O.

DEMPSEY

BELL

PARISVIEW DRIVE

N 60 - 30 E 300.0'

S 60 - 32 W 299.7'

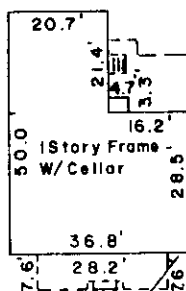

O.H. Power

Nail in Tree Root
I.P.N. 99.8'

N 29 - 08 W 99.8'

N. MAIN STREET

G. & N. RAILROAD

SURVEY FOR
DONALD KEITH PRESSLEY
FREDA S. PRESSLEY
TRAVELERS REST SOUTH GREENVILLE COUNTY
CAROLINA

MARCH 23, 1983

24316

9-M-55

To The Best Of My Knowledge This Structure
Is Not In An Established Flood Zone.

MAR 25 1983

I Herby Certify That The Measurements As
Shown Above Are Correct And There Are No
Encroachments Or Projections Other Than
Shown.

I Herby Certify That The Ratio Of Precision
Of The Field Survey Is 1/5000 As
Shown Hereon And The Area Was Determined
By D. M. D. Method.

JEFFERY M. PLUMBLEE, INC.
LAND SURVEYING

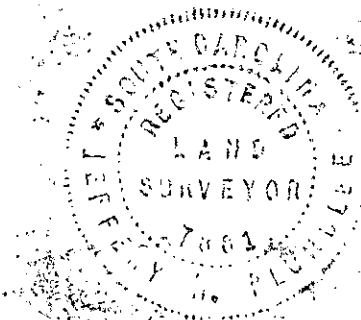

Jeffery M. Plumblee
R.L.S. # 7881

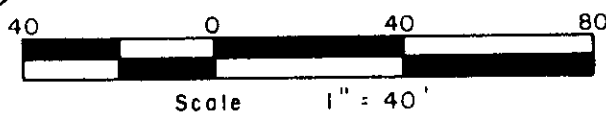

5.0001
P O BOX 788
TRAVELERS REST, S C 29690 (803) 834-4426

495-48

F.B. 11