

FILED
GREENVILLE CO. S.C.
MAR 7 9 16 AM '83
DONNIE S. TAUBERSLEY
R.M.C.

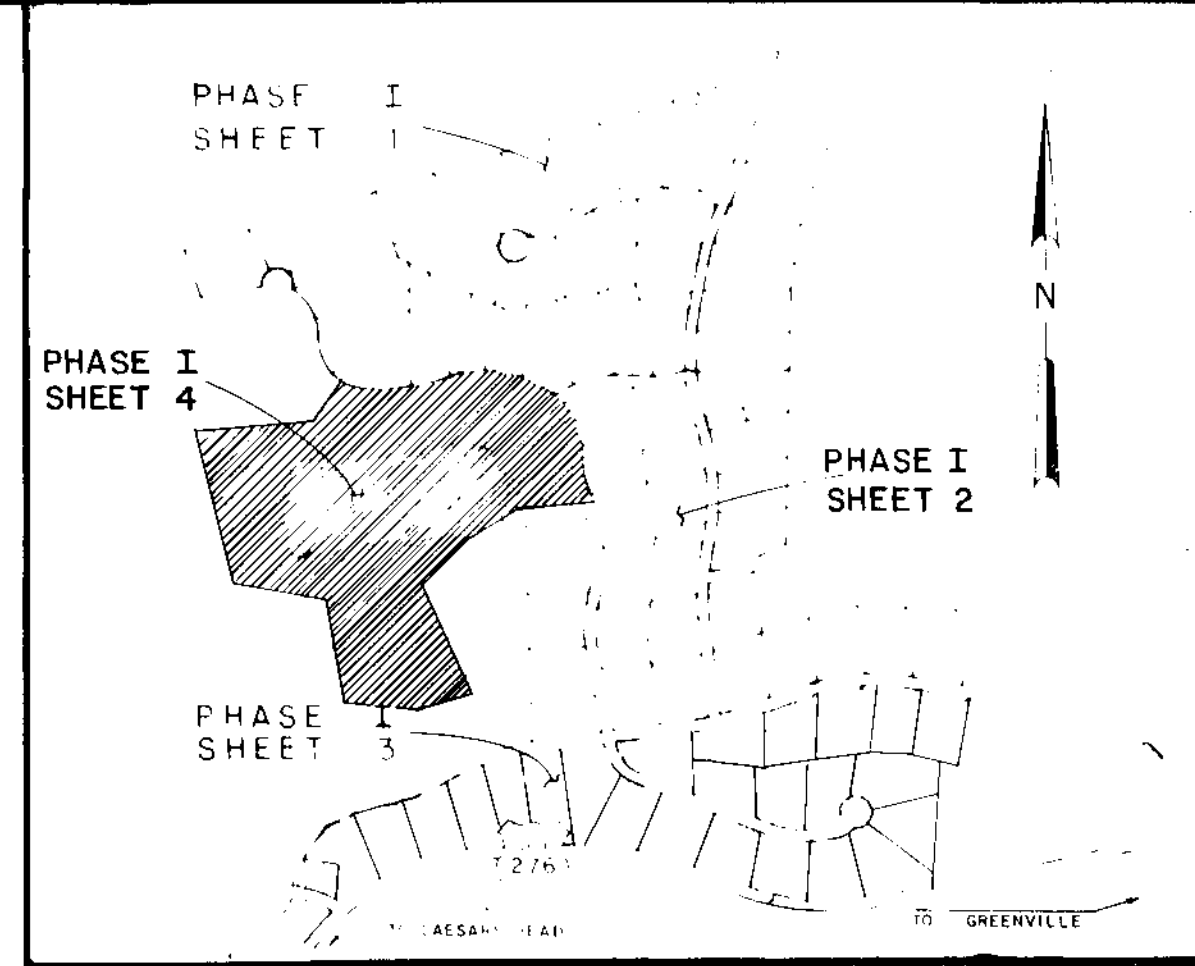
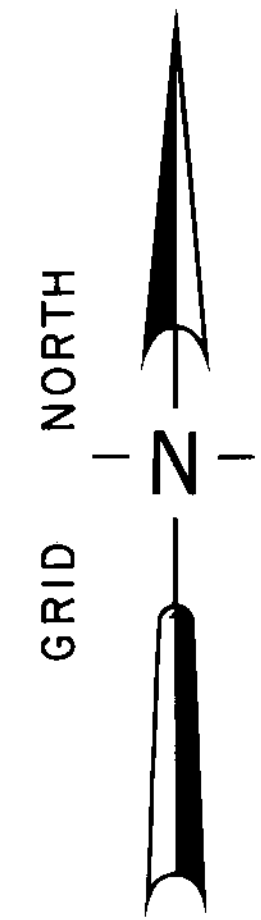
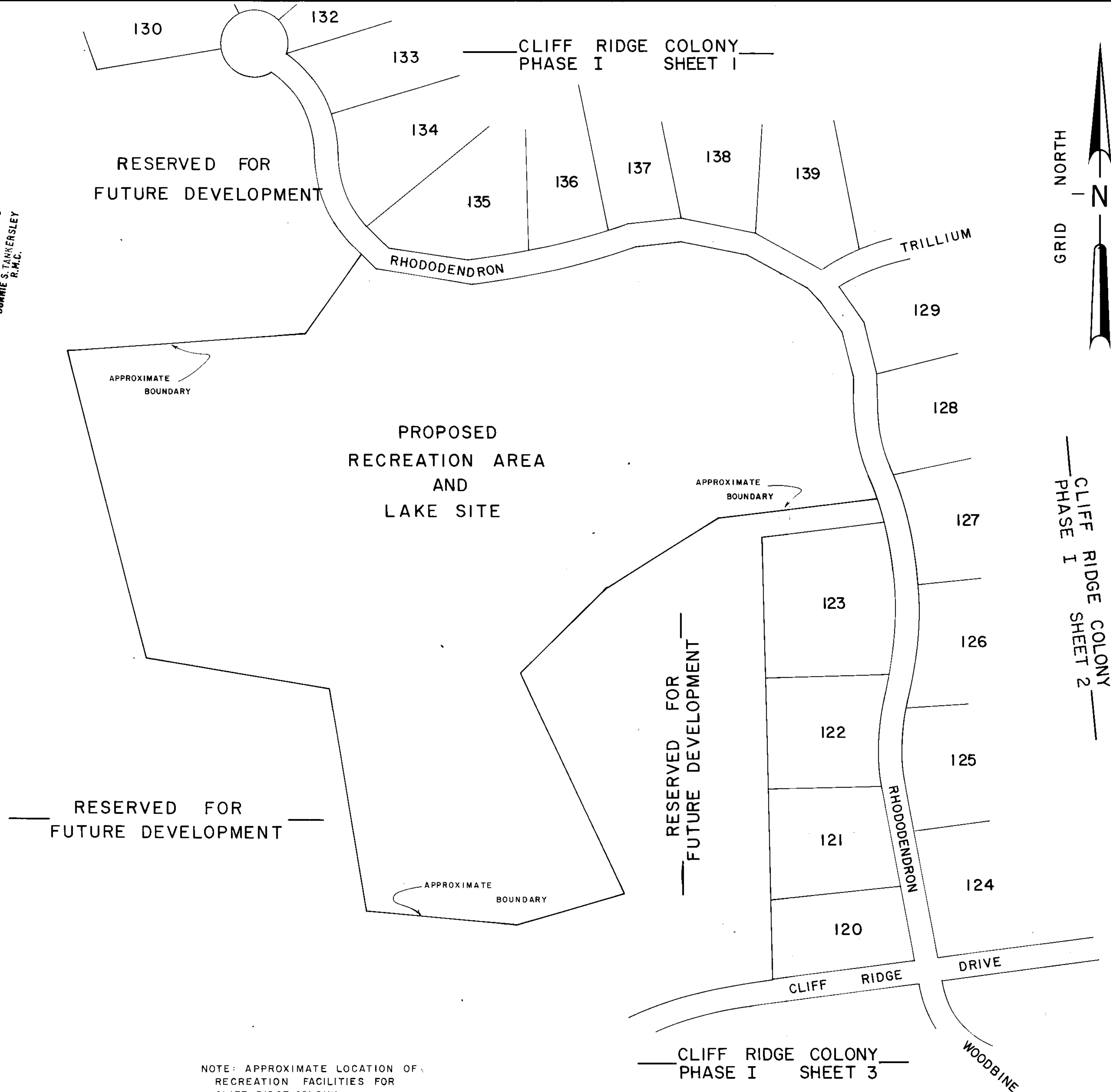

THIS PLAT IS NOT A SUBDIVISION AS DEFINED BY THE GREENVILLE COUNTY SUBDIVISION REGULATIONS.

3/7/83 *F. J. Fisher*
Chairman, Secretary, or Director of Planning,
Greenville County Planning Commission

FILE NUMBER

CLIFF RIDGE COLONY
PHASE I, SHEET 4

COLLEGE PROPERTIES, INC. ARBOR ENGINEERING, INC.
OWNER SURVEYOR

NO. OF ACRES: 118.7 ± MILES NEW ROAD: 1.67
NO. OF LOTS: 81 DATE: 6 DEC. 1982

100 0 100 200	
scale 1"=100' feet	
GREENVILLE SOUTH CAROLINA	
DRAWN	DESIGN
DPB	CJR
FILE	CHECK
SCALE	DATE
1"=100'	6 DEC. 1982
4 of 4	81260

NOTE: APPROXIMATE LOCATION OF RECREATION FACILITIES FOR CLIFF RIDGE COLONY.
RECORDED FOR INFORMATION PURPOSES ONLY.

Plat Filed This 7 day of March, 1983
And Recorded in Vol. 9J Page 73 at 9:16 AM
Donnie S. Taubersley
Register Mesne Conveyance Greenville County, S. C.

2152
98-73

3-7-83
RECORDED FOR INFORMATION PURPOSES ONLY
PAID \$ 5.00

Arbor Engineering, Inc.
P.O. BOX 263, GREENVILLE, S.C.
LANDSCAPE ARCHITECTS-ENGINEERS RECREATIONAL PLANNERS

ARBOR ENGINEERING

