

Note: Improvements on this lot are not in a flood hazard area.

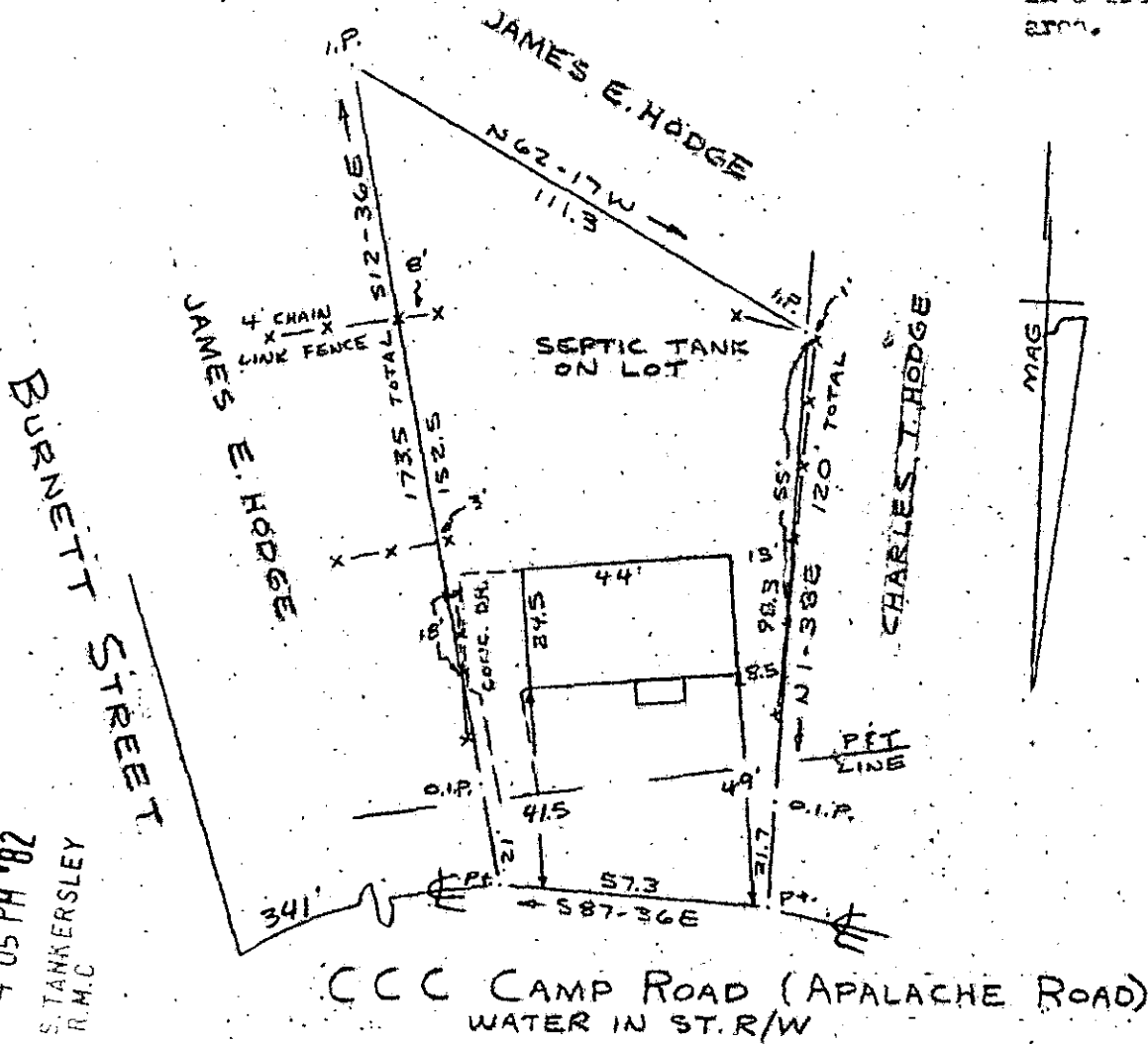

FILED  
 GREENVILLE CO. S.C.  
 DEC 1 4 05 PM '82  
 DONNIE S. TANKERSLEY  
 R.M.C.

PROPERTY OF  
**JAMES E. HODGE & SARA M. HODGE**  
 NEAR GREER, GREENVILLE CO., S.C.  
 SCALE: 1"=40' 9 NOV. 1982

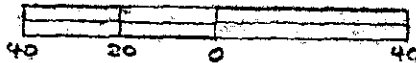

This is to certify that on the 9th day of November, 1982, I surveyed the property shown on this plat, being known as PROPERTY OF JAMES E. HODGE & SARA M. HODGE and recorded in the REC Office Greenville County, S. C., in Plat Book at Page ; and that the property lines, walls and buildings are as shown hereon, and that the walls and buildings located on said lot do not encroach or project on adjacent street or property, and that no adjacent walls or buildings encroach or project on said premises, and no power lines cross this property, except as shown hereon.

DEC 1 1982 13294

*R. B. [Signature]*  
 R. B. [Signature]  
 REC'D  
 1982  
 [Circular Stamp]

9-1-67

CAROLINA SURVEYING CO.  
 112 Holly St.  
 Greenville, S.C.

1081056 R 002