

20 AC. PARCEL FROM 1970 SURVEY  
 3 AC. PARCEL FROM ADJOINING SURVEY

FILED  
 11-05 AM '83  
 DONALD S. HARSHLEY  
 R.M.C.

CENTER LINE OF 50' R/W FOR  
 INGRESS AND EGRESS

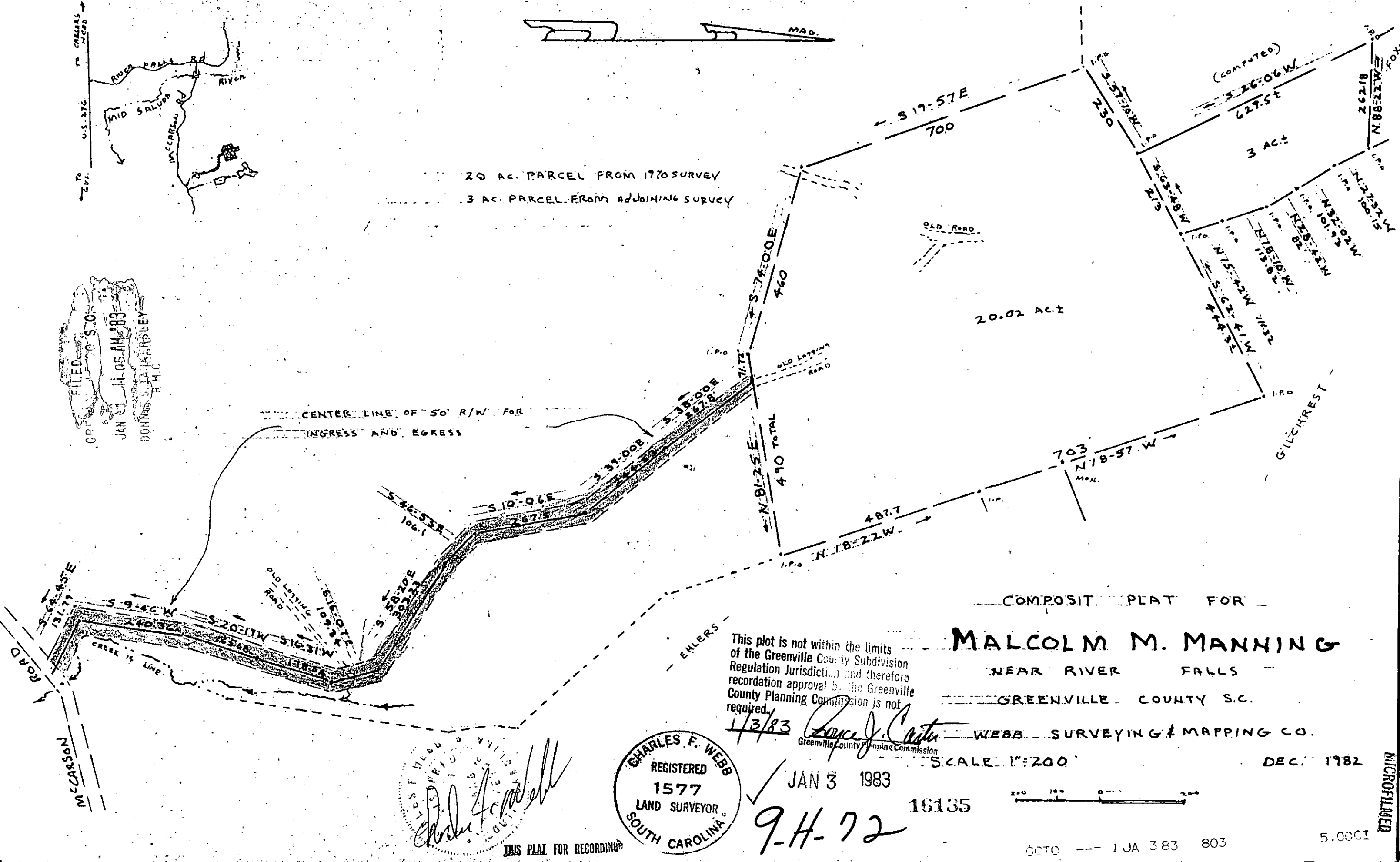

COMPOSITE PLAT FOR  
**MALCOLM M. MANNING**  
 NEAR RIVER FALLS  
 GREENVILLE COUNTY S.C.

This plot is not within the limits  
 of the Greenville County Subdivision  
 Regulation Jurisdiction and therefore  
 recordation approval by the Greenville  
 County Planning Commission is not  
 required.

1/3/83 *Royce J. Carter*  
 Greenville County Planning Commission  
 WEBB SURVEYING & MAPPING CO.

SCALE 1"=200'

DEC. 1982

CHARLES F. WEBB  
 REGISTERED  
 1577  
 LAND SURVEYOR  
 SOUTH CAROLINA

JAN 3 1983

9-H-72

16135

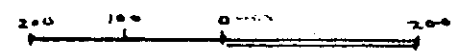

GCTD --- 1 JA 3 83 803

5.0001

MICROFILMED

*[Signature]*  
 THIS PLAT FOR RECORDING