

MICROFILMED

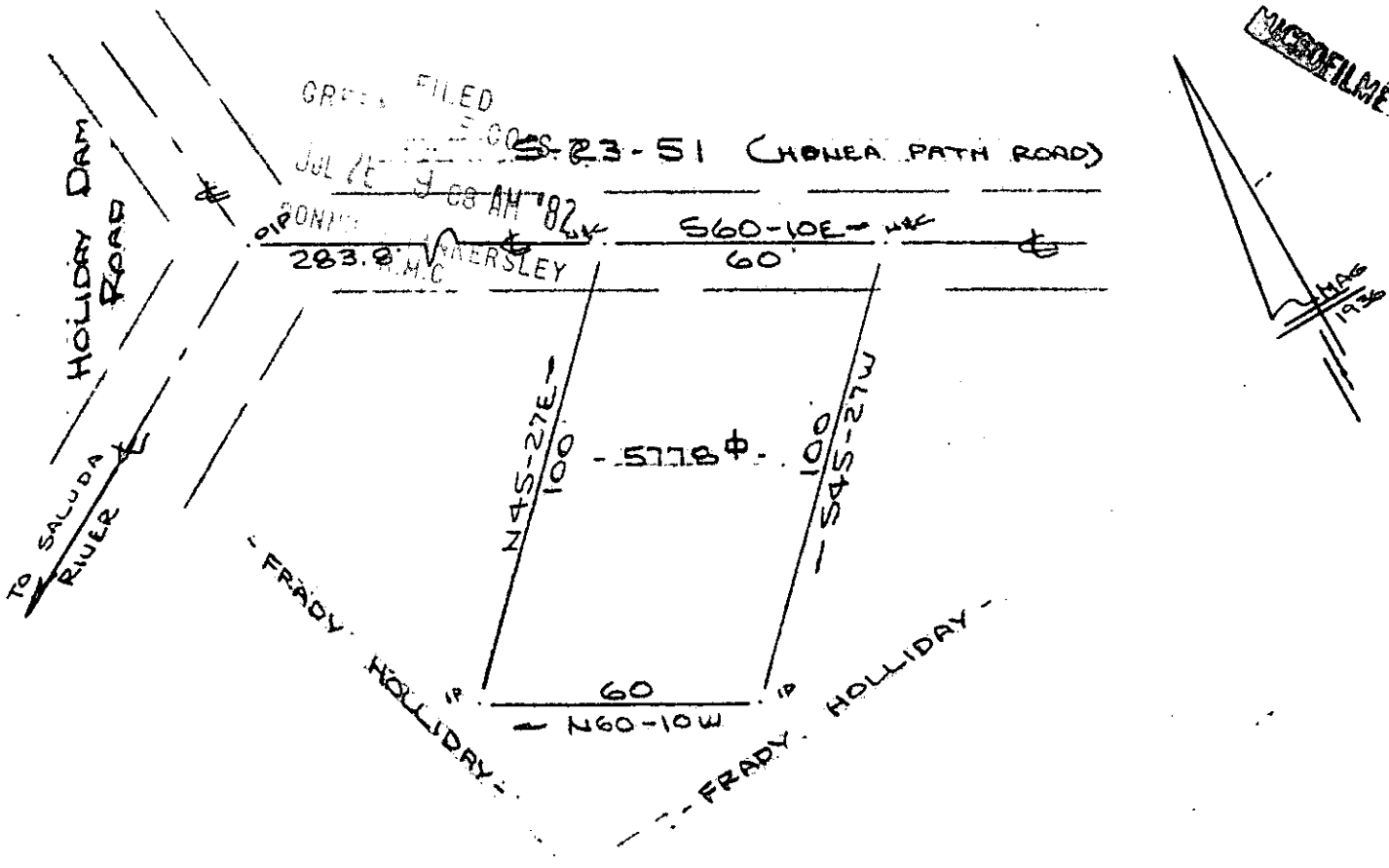

SURVEY FOR
 POSSEUM KINGDOM FIRE DEPARTMENT NO. 2
 GREENVILLE COUNTY S.C.
 SCALE: 1"=40' 20 JULY 1982

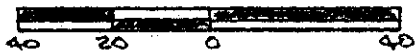

2245
 9-C-99
 JUL 28 1982

I Certify That The Ratio Of Precision Of The Field Survey
 is 1/2500 As Shown Hereon And That The Area
 Determined By D.M.D. Method Of Area Calculations.

R. B. Brubaker



CAROLINA SURVEYING CO.
 112 MAINLY ST.
 GREENVILLE, S.C.

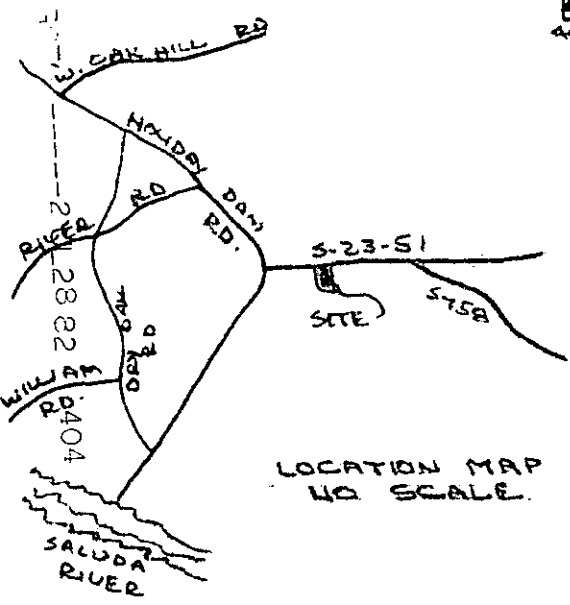

LOCATION MAP
 NO SCALE.

4.00CI