

LEGEND

○	I.P. SET	◊	STONE
●	I.P. FOUND	⦿	R.R. SPIKE

I hereby certify that the ratio of precision of the field survey is 1/ as shown hereon and the area was determined by the coordinate method of area calculation.

I hereby certify that the measurements as shown on this plat are correct and that there are no encroachments or projections other than shown.

SOUTH CAROLINA
REGISTERED
LAND
SURVEYOR
THOMAS D. LINDSEY
8049

Thomas D. Lindsey 10-19-81
SIGNATURE DATE

PROPERTY OF
HART GRAPHICS
SURVEYED FOR
CITY OF SIMPSONVILLE
GREENVILLE COUNTY SOUTH CAROLINA

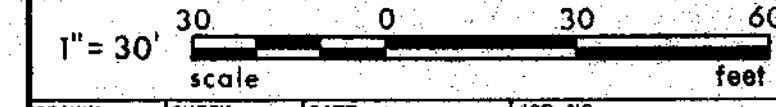

DRAWN TDL	CHECK TDL	DATE 12 OCT 1981	JOB NO. 1403
--------------	--------------	---------------------	-----------------

LINDSEY & ASSOCIATES
HWY. 253 RT. 1, TAYLORS S.C. 29687
LAND & HYDROGRAPHIC SURVEYORS

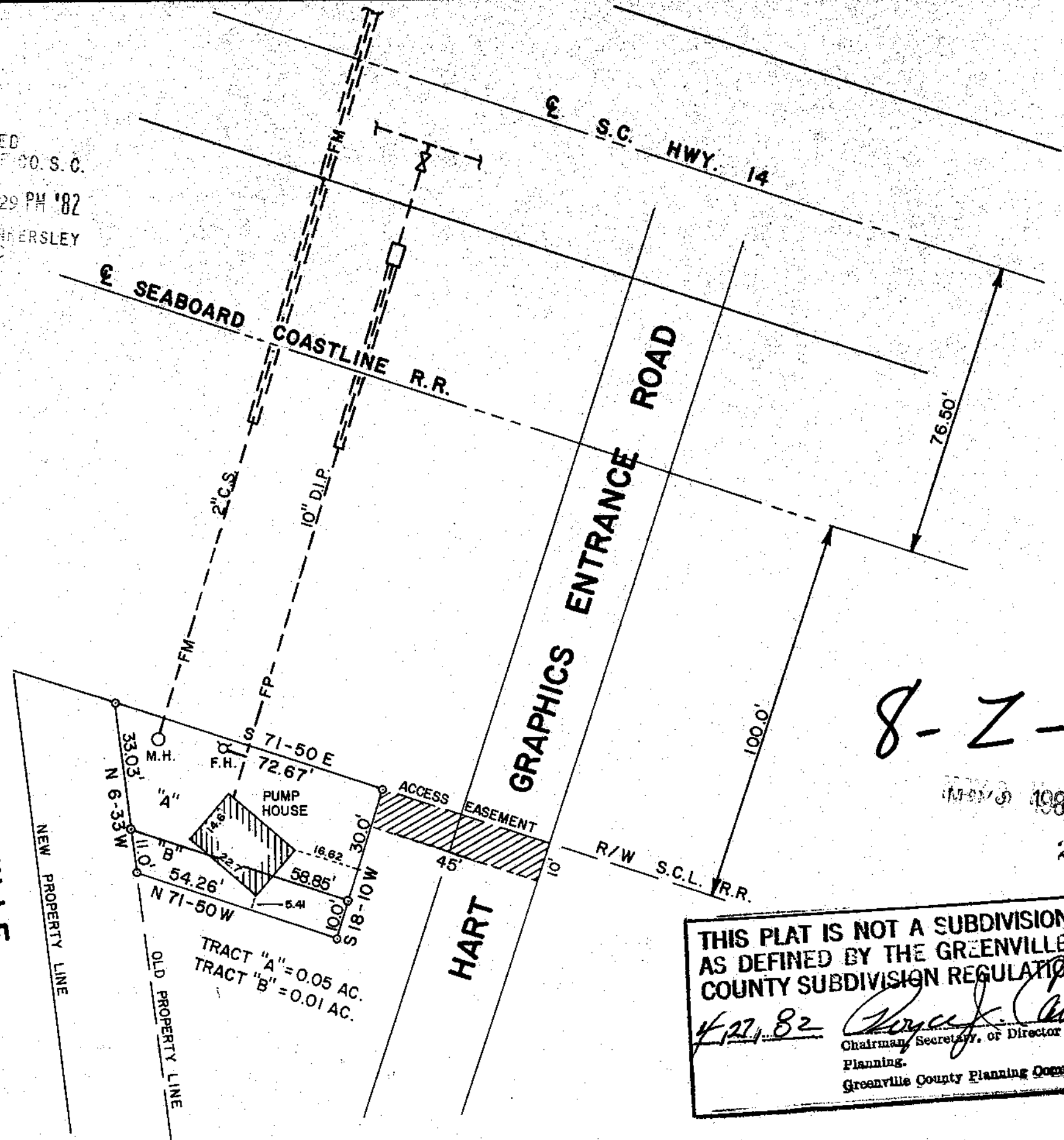

FILED
GREENVILLE CO. S.C.
MAY 3 1 29 PM '82
DONNIE S. TAMMERSLEY
R.M.C.

GREENVILLE COUNTY SCHOOL

TRACT "A" = 0.05 AC.
TRACT "B" = 0.01 AC.

THIS PLAT IS NOT A SUBDIVISION AS DEFINED BY THE GREENVILLE COUNTY SUBDIVISION REGULATIONS.

4/27/82 *Wayne J. Carter*
Chairman, Secretary, or Director of Planning.
Greenville County Planning Commission

8-Z-46

MAY 3 1982 ✓
24461