

"THIS IS TO CERTIFY THAT THE ERROR OF CLOSURE OF THIS SURVEY IS 1 IN 10,000[±], AND THE ACREAGE HAS BEEN DETERMINED BY THE D.M.D. METHOD." *J. L. M. III*

MICROFILMED

"THIS PLAT TO BE RECORDED IN THE R.M.C. OFFICE."

MAGNETIC NORTH

"THIS PROPERTY IS NOT IN A U.S.G.S. DESIGNATED FLOOD PLAIN." *J. L. M. III*

GREENVILLE CO. S.C.
MAR 22 2 01 PM '82
DONNIL S. TANKERSLEY
R.M.C.

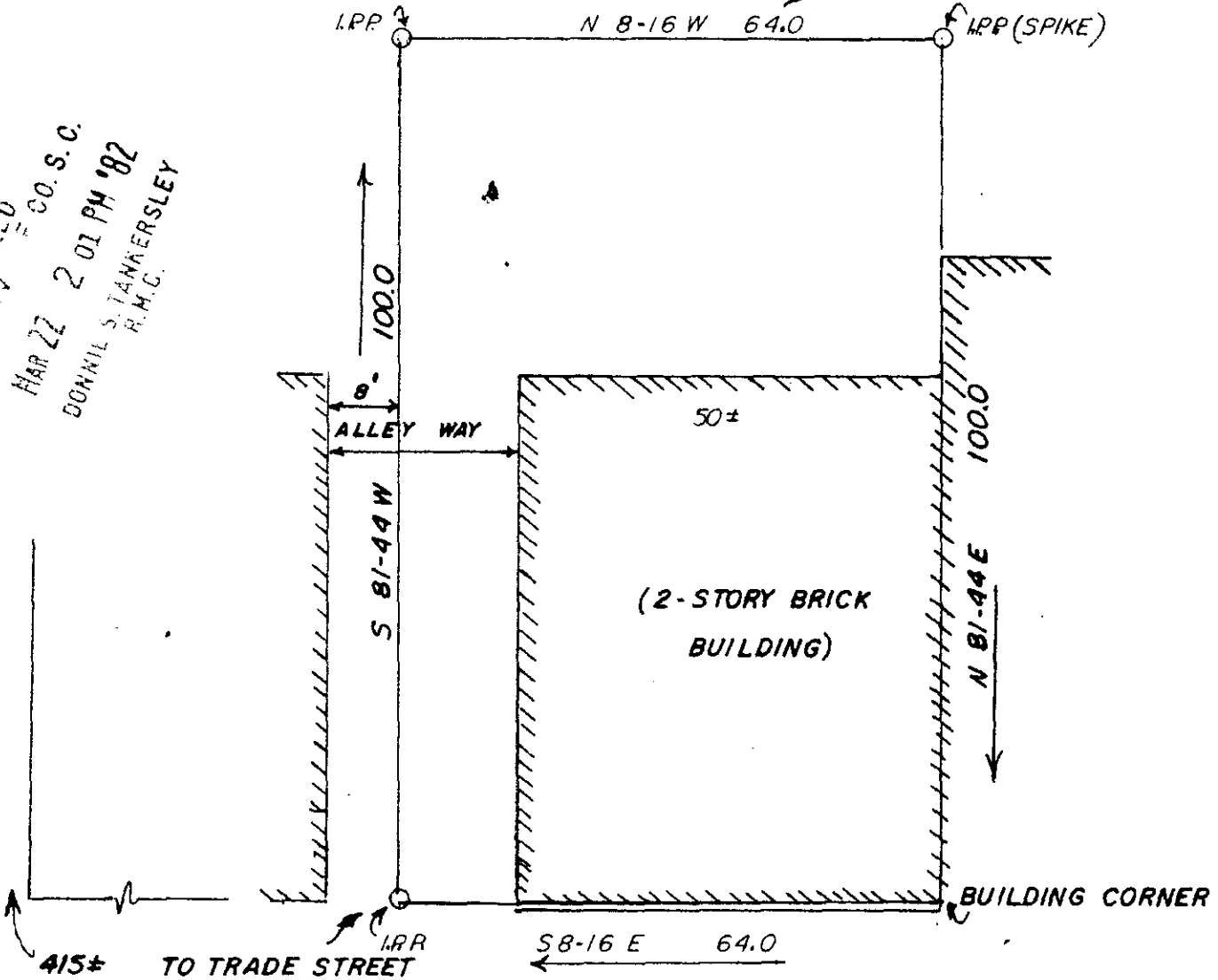

SOUTH MAIN STREET

21089

8-Y-53

MAR 22 1982

J. L. MONTGOMERY, III
Registered Professional Surveyor
NORTH MAPLE STREET
SIMPSONVILLE, S.C. 2968

PREPARED FOR:

S. HUNTER HOWARD, SR. & S. H. HOWARD, JR.



SCALE: 1"=40'	APPROVED BY: <i>J. L. Montgomery, III</i>	DRAWN BY: <i>JL</i>
DATE: 3-17-82	SIMPSONVILLE GREENVILLE COUNTY SOUTH CAROLINA	REVISED
DRAWING NUMBER 019		3 0000

EB30-82