

FILED
GREENVILLE CO. S.C.
OCT 9 3 34 AM '81
DONNIE S. TANKERSLEY
R.M.C.

FILED
GREENVILLE CO. S.C.
OCT 9 3 34 AM '81
DONNIE S. TANKERSLEY
R.M.C.

WINDING WAY

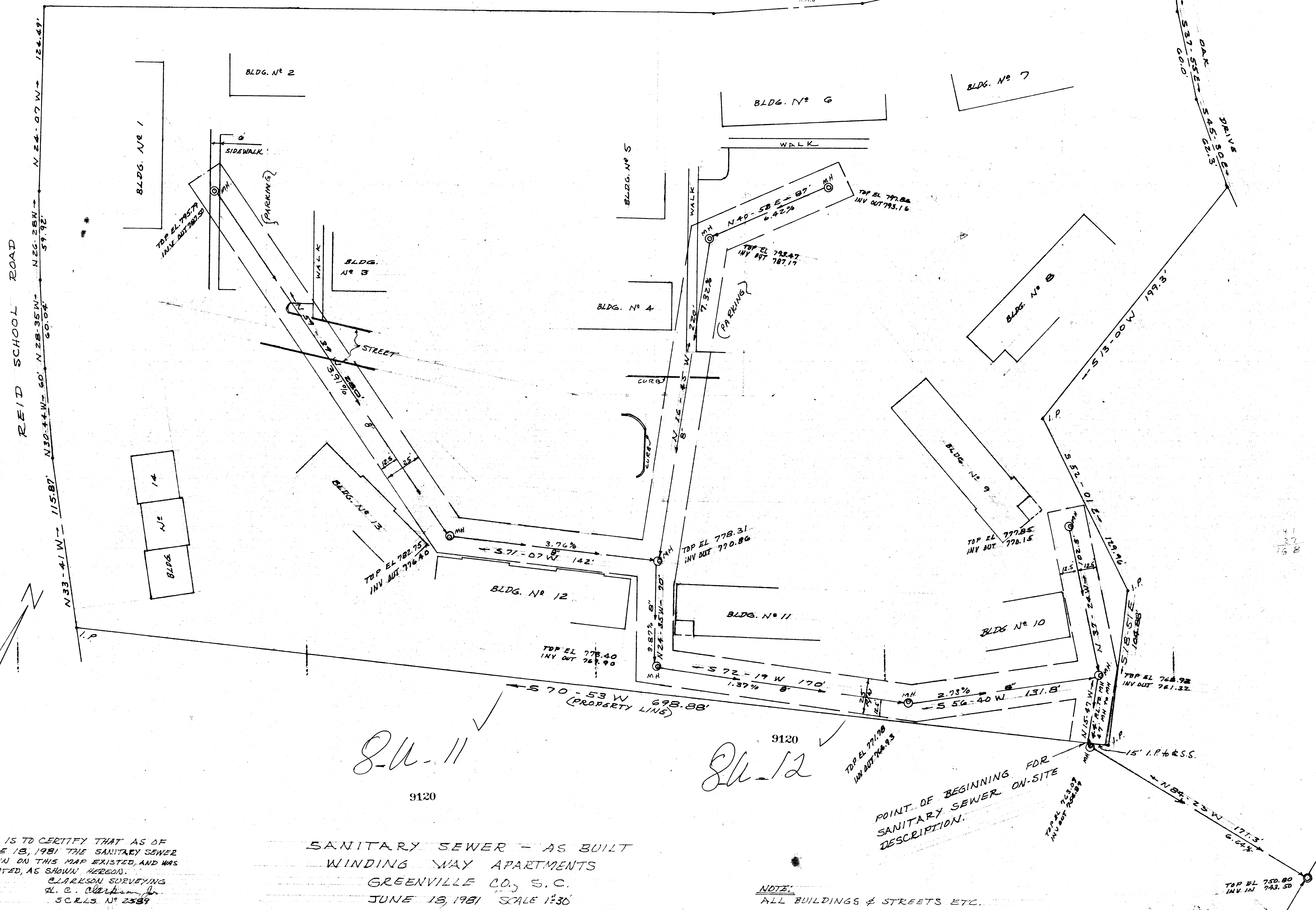

9120
S-U-11

9120
S-U-12

POINT OF BEGINNING FOR
SANITARY SEWER ON-SITE
DESCRIPTION.

THIS IS TO CERTIFY THAT AS OF
JUNE 18, 1981 THE SANITARY SEWER
SHOWN ON THIS MAP EXISTED, AND WAS
SITUATED, AS SHOWN HEREON.
CLARKSON SURVEYING
L. C. Clarkson, Jr.
S.C.L.S. NO. 2389

SANITARY SEWER - AS BUILT
WINDING WAY APARTMENTS
GREENVILLE CO., S.C.
JUNE 18, 1981 SCALE 1"=30'

NOTE:
ALL BUILDINGS & STREETS ETC.
UNDER CONSTRUCTION - ALL
BUILDING FOUNDATIONS EXIST.