

S. C. HWY. NO. 291
S. PLEASANTBURG DRIVE

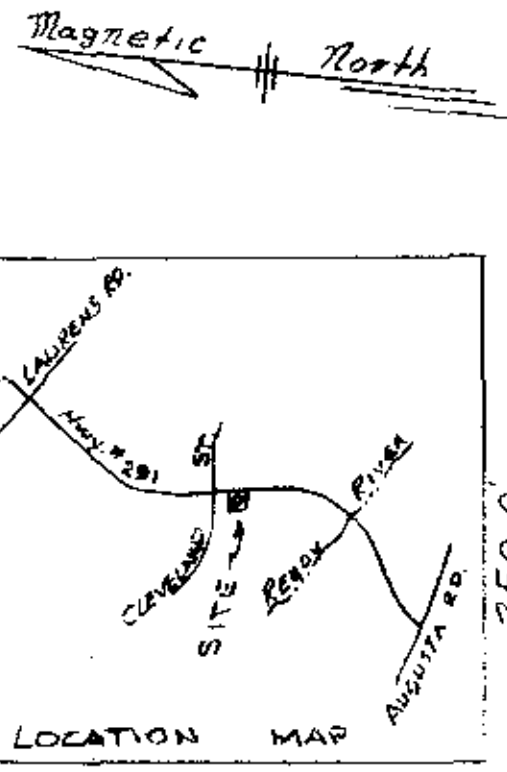
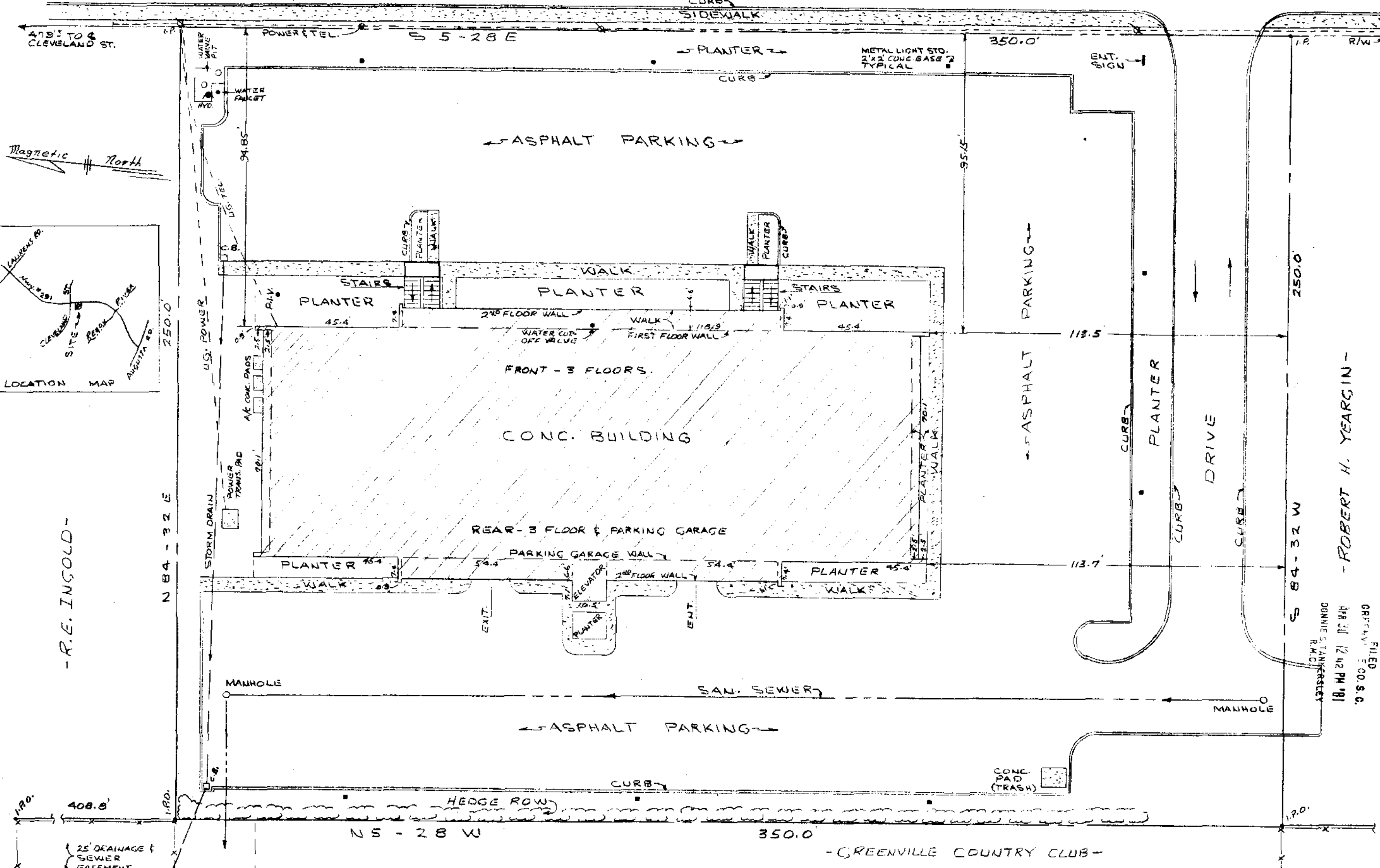

-R.E. INGOLD-

-ROBERT H. YEARGIN-

PROPERTY OF
UNITED STATES TRUST COMPANY AS TRUSTEES ETAL
CITY OF GREENVILLE, S. C.
SCALE 1"=20' - MARCH 30, 81

GRAPHIC SCALE
PIEDMONT SURVEYOR
GREENVILLE, S.C.

30456

APR 30 81 N-23

I CERTIFY THAT THIS PLAN WAS PREPARED FROM AN ACTUAL FIELD SURVEY MADE UNDER MY SUPERVISION.
JAMES O. CRAIN
JAMES O. CRAIN RLS NO. 3320

FILED
APR 30 12 42 PM '81
DONNIE S. TANNER
R.M.C.