

Sta.	Bearing	Dist.	Sta.	Bearing	Dist.	Sta.	Bearing	Dist.	Sta.	Bearing	Dist.	Sta.	Bearing	Dist.	Sta.	Bearing	Dist.
1-2	S37-17W	44.04	33-34	N58-00W	178.89	65-66	N73-20W	82.44	97-98	N60-15E	54.46	129-130	N76-09E	123.05	161-162	N35-50E	92.35
2-3	S58-06E	117.33	34-35	N31-12W	153.34	66-67	S67-50W	80.84	98-99	N48-41E	75.30	130-131	S79-17E	105.26	162-163	S46-36E	104.85
3-4	S42-05E	139.85	35-36	N55-39W	71.22	67-68	S84-19W	114.48	99-100	N74-54E	140.76	131-132	S71-45E	111.85	163-164	S68-13E	100.83
4-5	S37-38E	200.21	36-37	N33-23W	225.55	68-69	N85-40W	175.69	100-101	S84-22E	70.59	132-133	S39-13E	73.70	164-165	N88-18E	165.69
5-6	S47-39E	157.98	37-38	N39-37W	134.70	69-70	N55-40W	121.68	101-102	S48-05E	71.42	133-134	S71-49E	121.29	165-166	N68-21E	103.18
6-7	S30-23E	36.53	38-39	S78-14W	101.97	70-71	S69-30W	180.68	102-103	S76-23E	42.17	134-135	N84-23E	108.17	166-167	N46-28E	61.67
7-8	S03-29E	43.00	39-40	N52-02W	95.37	71-72	N82-37W	334.11	103-104	N74-59E	181.24	135-136	S11-00E	115.35	167-168	N20-43E	67.77
8-9	S09-29W	99.34	40-41	N18-21W	174.44	72-73	N57-01W	39.36	104-105	N64-21E	93.65	136-137	S69-59E	173.21	168-169	N07-51E	66.66
9-10	N39-47W	90.47	41-42	S77-23W	153.90	73-74	N42-52W	64.18	105-106	N87-31E	164.79	137-138	S55-07E	103.48	169-170	N54-05E	120.06
10-11	N51-28W	159.11	42-43	N46-50W	112.58	74-75	N70-04W	47.98	106-107	S75-31E	70.16	138-139	S63-02E	58.91	170-171	S89-31E	85.26
11-12	N55-20W	102.38	43-44	N56-21W	112.26	75-76	S85-11W	67.92	107-108	S84-03E	102.51	139-140	N72-29E	139.97	171-172	N78-40E	138.99
12-13	N85-54W	173.79	44-45	N29-42W	125.05	76-77	S63-01W	101.56	108-109	N63-01E	104.55	140-141	S29-42E	107.94	172-173	S85-54E	161.53
13-14	S78-40W	139.95	45-46	S72-29W	151.92	77-78	N84-03W	91.40	109-110	N85-11E	55.46	141-142	S56-21E	116.87	173-174	S55-20E	93.17
14-15	N89-31W	92.01	46-47	N63-02W	44.57	78-79	N75-31W	72.40	110-111	S70-04E	34.14	142-143	S46-50E	125.96	174-175	S51-28E	154.46
15-16	S54-05W	142.73	47-48	N55-07W	105.32	79-80	S87-31W	175.41	111-112	S42-52E	49.90	143-144	N77-23E	142.64	175-176	S45-24E	111.54
16-17	S07-51W	76.08	48-49	N69-59W	160.15	80-81	S64-21W	97.01	112-113	S57-01E	49.90	144-145	S18-21E	156.38	176-177	N20-25E	133.60
17-18	S20-43W	57.53	49-50	N11-00W	125.69	81-82	S74-59W	170.79	113-114	S82-37E	348.37	145-146	S52-02E	118.36	177-178	N03-29W	54.78
18-19	S46-28W	49.01	50-51	S84-23W	129.16	82-83	N76-23W	26.95	114-115	N69-30E	172.56	146-147	N78-14E	97.80	178-179	N30-23W	48.26
19-20	S68-21W	92.10	51-52	N71-49W	106.20	83-84	N48-05W	73.69	115-116	S55-40E	114.16	147-148	S39-37E	128.67	179-180	N47-39W	159.90
20-21	S88-18W	154.18	52-53	N39-13W	73.58	84-85	N84-22W	85.91	116-117	S35-41E	186.36	148-149	S83-23E	230.19	180-181	N37-38W	198.75
21-22	N68-13W	88.87	53-54	N71-45W	122.58	85-86	S74-51W	153.24	117-118	N84-19E	121.45	149-150	S55-39E	57.31	181-182	N42-05W	145.25
22-23	N46-36W	133.37	54-55	N79-17W	113.77	86-87	S48-41W	79.24	118-119	N67-50E	74.61	150-151	S31-12E	153.99	182-183	N58-05W	88.66
23-24	S35-50W	116.98	55-56	S76-09W	118.67	87-88	S60-15W	46.68	119-120	S73-20E	78.41	151-152	S58-00E	191.99	183-184	N36-22E	7.61
24-25	S71-24W	317.91	56-57	N63-54W	137.29	88-89	S78-14W	127.04	120-121	N82-04E	137.38	152-153	S80-27E	176.02	184-1	N48-05W	30.00
25-26	S25-01W	111.94	57-58	S86-43W	516.37	89-90	S60-52W	80.32	121-122	S77-55E	68.92	153-154	N80-46E	30.34			
26-27	S41-15W	118.98	58-59	N72-28W	233.75	90-91	N76-34W	45-58	122-123	S53-57E	201.54	154-155	N64-32E	95.45			
27-28	S57-37W	84.60	59-60	N45-46W	130.00	91-92	N65-31W	253.09	123-124	S23-03E	132.06	155-156	N52-43E	88.85			
28-29	S63-56W	177.24	60-61	N61-08W	257.36	92-93	S48-45E	89.30	124-125	S61-08E	263.67	156-157	N63-56E	175.95			
29-30	S52-43W	88.69	61-62	N23-03W	130.00	93-94	S65-31E	171.35	125-126	S45-46E	133.07	157-158	N57-37E	90.57			
30-31	S64-32W	88.07	62-63	N53-57W	216.20	94-95	S76-34E	60.17	126-127	S72-28E	251.38	158-159	N41-15E	127.57			
31-32	S80-46W	21.10	63-64	N77-55W	80.59	95-96	N60-52E	87.43	127-128	N86-43E	514.01	159-160	N25-01E	103.37			
32-33	N80-27W	165.11	64-65	S82-04W	136.13	96-97	N76-14E	127.21	128-129	S63-54E	140.33	160-161	N71-24E	314.68			

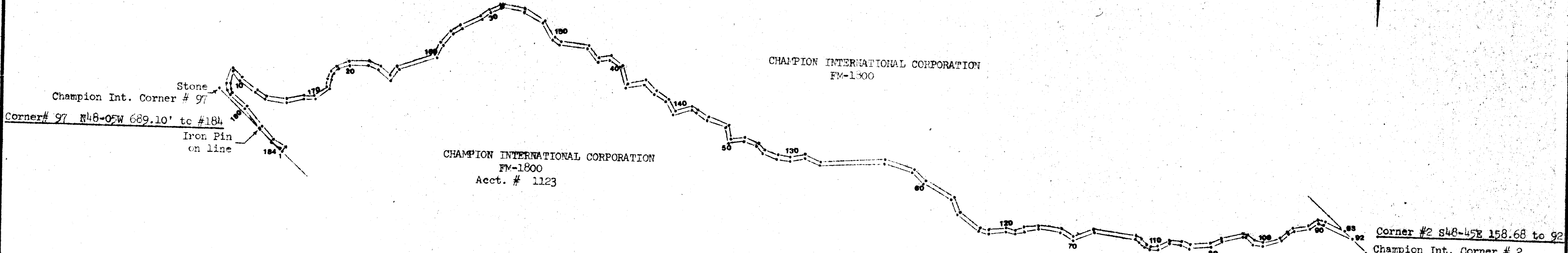

FILED
GREENVILLE CO. S. C.
DEC 29 3 14 PM '80
DONNIE STANKERSLEY
R.M.C.



I certify that I surveyed the above R-O-W and drew this plat.
John R. Long
SC RLS 16270

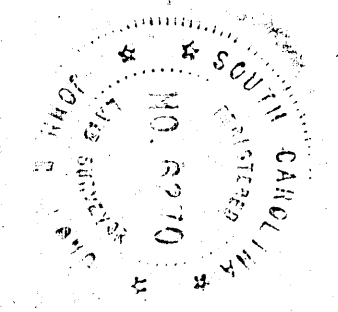

Paul W. Peoples

8-I-29
DEC 29 1980
18887

CHAMPION INTERNATIONAL CORPORATION to PAUL W. PEEPLES		
SCALE: 1"=660'	APPROVED BY	DRAWN BY
DATE: 03-26-80		
30' R-O-W Survey across Champion International Corp. property located on Hogback Mtn., in Greenville County, SC		
7.773 acres in R-O-W	DRAWING NUMBER	