

MICROFILMED

FILED
GREENVILLE S.C.
SEP 25 10 45 AM '80
DONNIE S. TANKERSLEY
R.M.C.

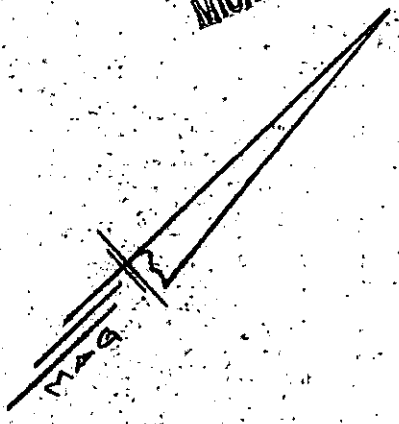
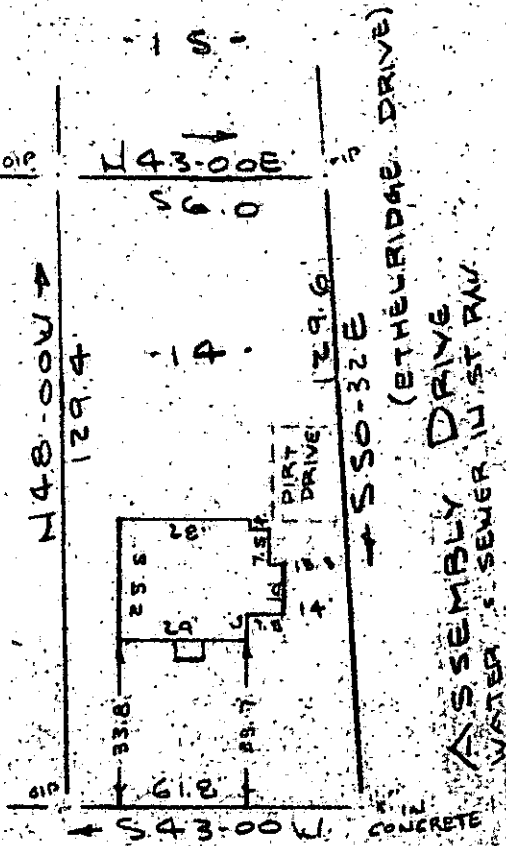

Note: Improvements on this lot are not in a flood hazard area.

PERRY ROAD
WATER SEWER IN STRAY

PROPERTY OF
JAMES D. HEADRICK & JENNIFER G. HEADRICK
NEAR GREENVILLE, SC
SCALE 1" = 40' 30 JULY 1980

This is to certify that on the 30th day of July, 1980, I surveyed the property shown on this plat, being known as lot 14 on plat of PROPERTY OF ETHEL Y. PERRY EST and recorded in the RMC Office Greenville County, S. C., in Plat Book "Q" at Page 24 and also being known as PROPERTY OF JAMES D. HEADRICK & JENNIFER G. HEADRICK and recorded in Plat Book at Page ; and that the property lines, walls and buildings are as shown hereon, and that the walls and buildings located on said lot do not encroach or project on adjacent street or property, and that no adjacent walls or buildings encroach or project on said premises, and no power lines cross this property except as shown hereon.

SEP 25 1980

8-6-16 ✓

B. D. Duce

R. D. Duce, RLS 1952

3629

CAROLINA SURVEYING
112 Manly St.
Greenville, S. C.

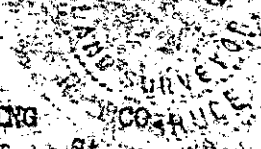

15CTO --- 1 SE 25 80 E50 3.0001