

ALLEY

FILED
GREENVILLE CO. S. C. 544-12E
47.2

Note: Improvements on this lot are not in a flood hazard area.

SEP 18 10 27 AM '80
DONNIE S. TANKERSLEY
R.M.C.

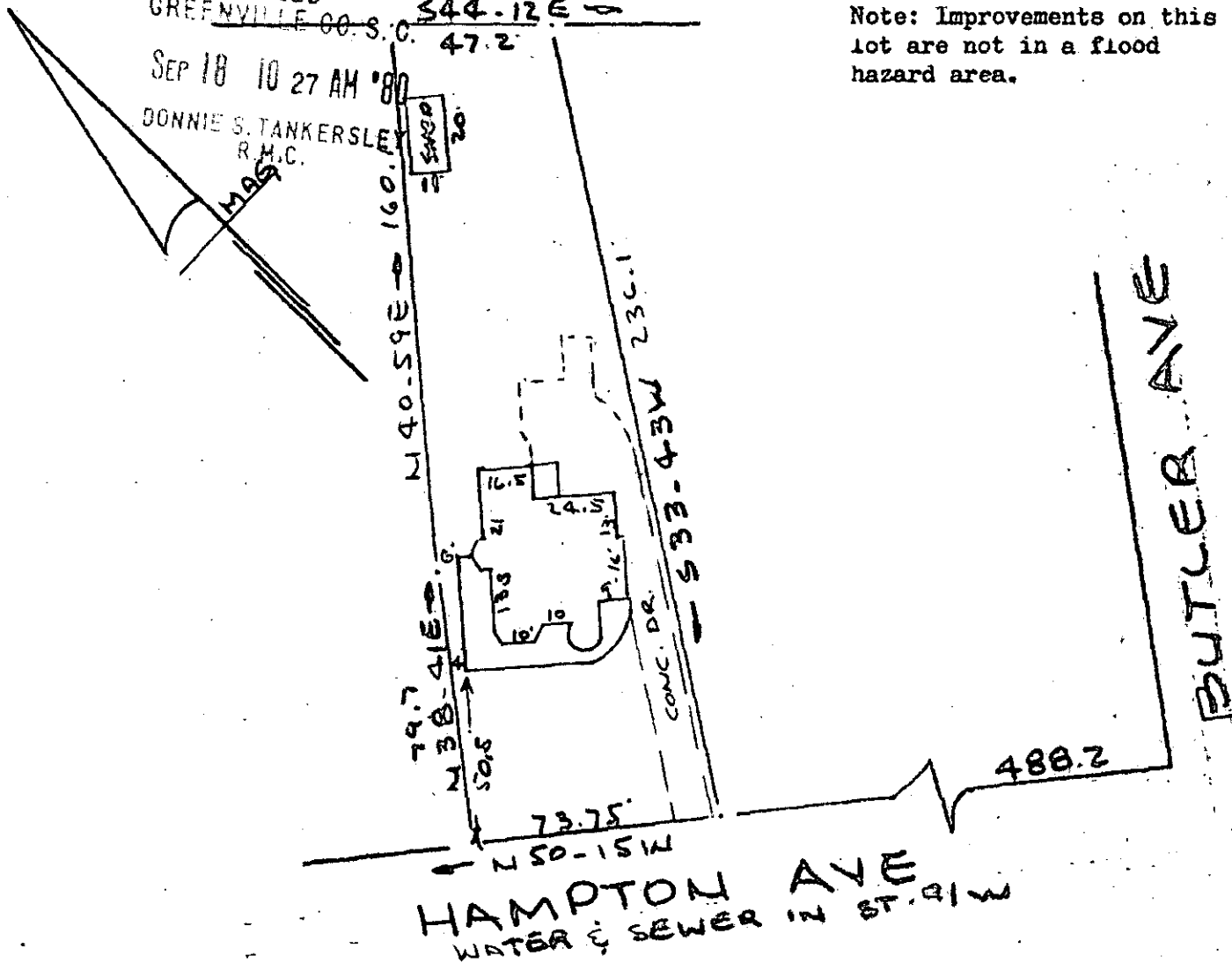

PROPERTY OF
DAVID JOSEPH NOVACK
GREENVILLE, S.C.
SCALE 1" = 50' 10 SEPT 1980

This is to certify that on the 10th day of September, 1980, I surveyed the property shown on this plat, being known as PROPERTY OF DAVID JOSEPH NOVACK and recorded in the RMC Office Greenville County, S. C., in Plat Book at Page ; and that the property lines, walls and buildings are as shown hereon, and that the walls and buildings located on said lot do not encroach or project on adjacent street or property, and that no adjacent walls or buildings encroach or projection said premises, and no power lines cross this property except as shown hereon.

8E-81 ✓ 8825

R. B. Bruce
R. B. Bruce, RLS #195
SULLY AND SULLY
SURVEYORS
GREENVILLE, S. C.

SEP 18 1980

CAROLINA SURVEYING CO.
112 Manly St.
Greenville, S. C.

GCTO --- 1 SE18 80 1507 3.00C1

224/66

18-1-21