

LAKEWOOD DRIVE
WATER IN ST RAW

FILED
JUL 8 2 12 PM '80
GREENVILLE CO. S. C.
DONNIE R. TANKERSLEY
R.M.C.

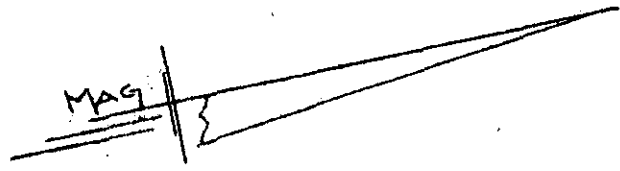
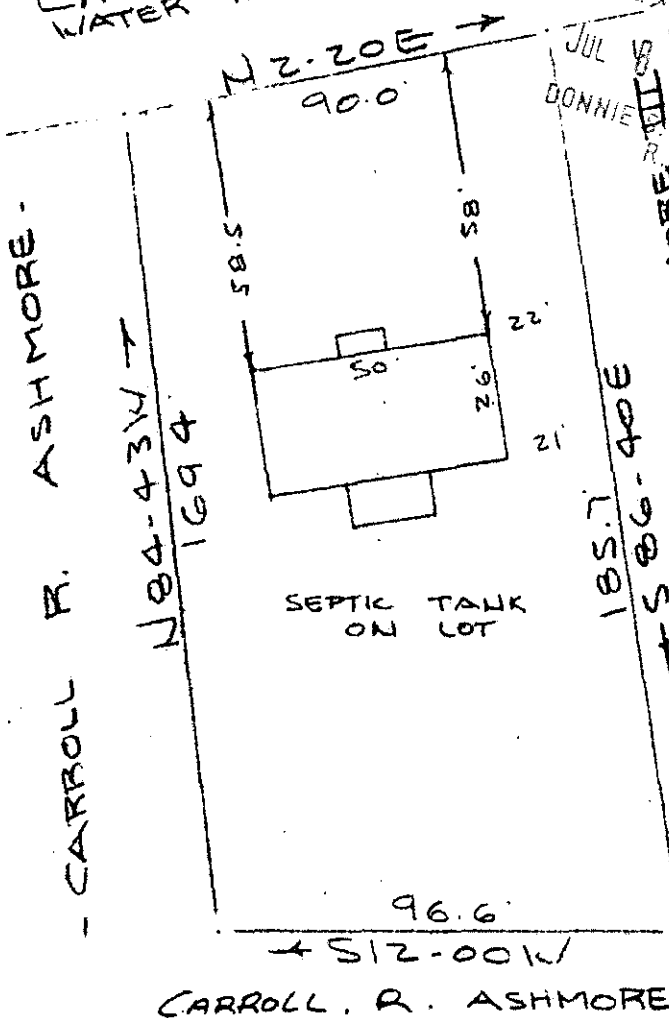

Note: Improvements on this lot are not in a flood hazard area.

PROPERTY OF
ROBERT LOUIS ASHMORE
NEAR GREENVILLE, S.C.
SCALE: 1" = 40'
3 JULY 1980

This is to certify that on the 3rd day of July, 1980, I surveyed the property shown on this plat, being known as a portion of CARROLL R. ASHMORE PROPERTY and also known as PROPERTY OF ROBERT LOUIS ASHMORE and recorded in the RMC Office Greenville County, S. C., in Plat Book 8-C at Page 18; and that the property lines, walls and buildings are as shown hereon, and that the walls and buildings located on said lot do not encroach or project on adjacent street or property, and that no adjacent walls or buildings encroach or project on said premises, and no power lines cross this property except as shown hereon.

8-C-18
562

JUL 8 1980

B. B. Bruce

R. B. Bruce, RLS #19521 AND
CO. St. C.

CAROLINA SURVEYING
112 Manly St.
Greenville, S. C.

GCIC --- JUL 8 1981 1006 3.00CI