

Note: Improvements on this lot are not in a flood hazard area.

FILED
GREENVILLE CO. S. C.

MICROFILMED

APR 4 3 32 PM '80

DONNIE S. TANKERSLEY
R.M.C.

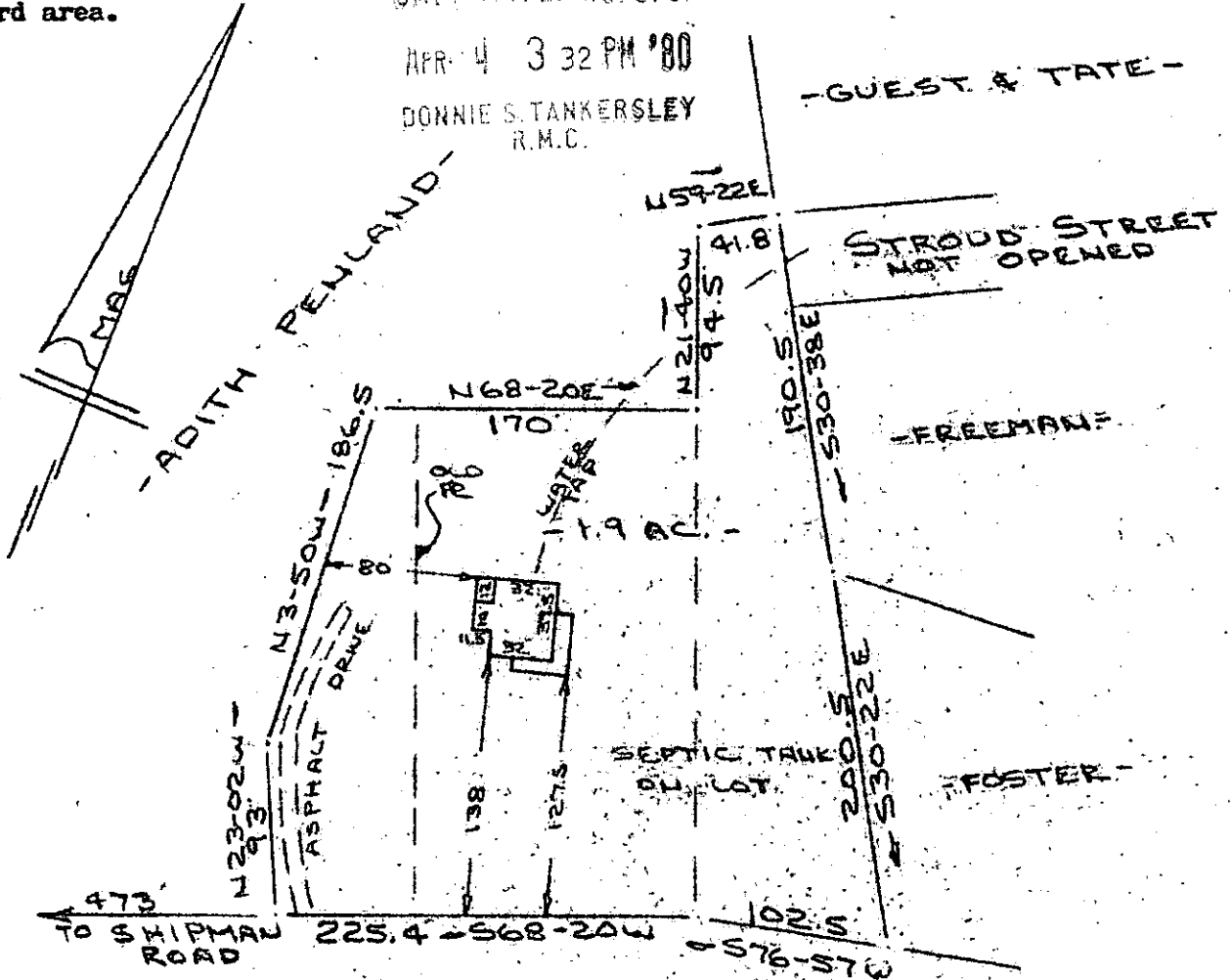

DACUSVILLE ROAD
(S. C. HIGHWAY #186)
WATER IN RD R/W

PROPERTY OF
BOBBY N. CANTRELL & MARGARET CANTRELL
NEAR GREENVILLE, S. C.
SCALE: 1"=100' 2 APR 1980

This is to certify that on the 2nd day of April, 1980, I surveyed the property shown on this plat, being known as 1.9 acre on plat of PROPERTY OF BOBBY N. CANTRELL & MARGARET CANTRELL and recorded in the RMC Office Greenville County, S. C., in Plat Book _____ at Page _____; and that the property lines, walls and buildings are as shown hereon, and that the walls and buildings located on said lot do not encroach or project on adjacent street or property, and that no adjacent walls or buildings encroach or project on said premises, and no power lines cross this property except as shown hereon.

✓ 7W-82 29607

R. B. Brund
R. B. Brund, R.M.C. 1952

CAROLINA SURVEYING CO.
112 Manly St.
Greenville, S. C.