

MICROFILMED

THIRD AVE (JUDSON ROAD)  
WATER & SEWER IN ST R/W

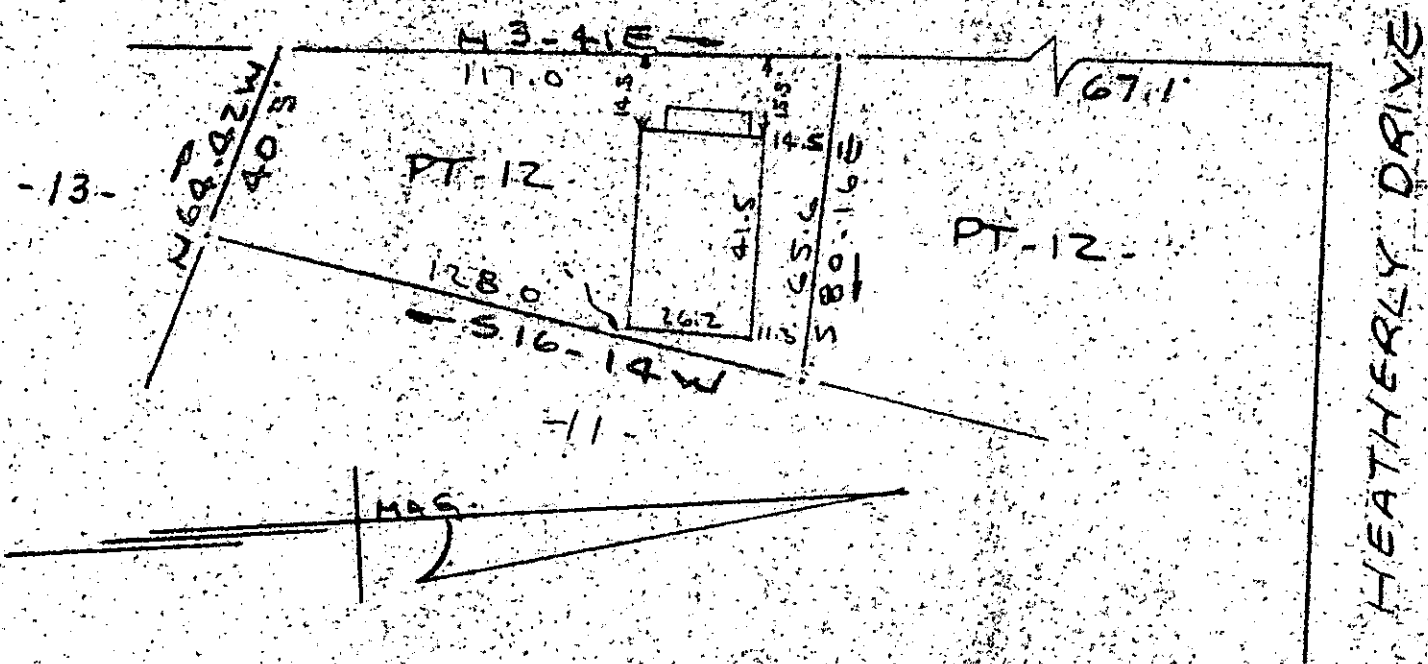

FILED  
GREENVILLE CO. S. C.  
JUN 4 10 59 AM '79  
DONNIE S. TANKERSLEY  
R.M.C.

NOTE: Improvements on this lot are not in a flood hazard area.

PROPERTY OF  
JAMES B. BLANDIN & RITHA ANN BLANDIN  
NEAR GREENVILLE S.C.  
SCALE 1" = 40' 29 MAY 1979

This is to certify that on the 29th day of May, 1979, I surveyed the property shown on this plat, being known as part of lot 12 on plat of Tract No. 8 of JUDSON MILL PROPERTY SUBDIVISION and recorded in the RMC Office Greenville County, S. C., in Plat Book "E" at Page 235; and also being known as PROPERTY OF JAMES BLANDIN & RITHA ANN BLANDIN and recorded in the Plat Book at Page ; and that the property lines, walls and buildings are as shown hereon, and that the walls and buildings located on said lot do not encroach or project on adjacent street or property, and that no adjacent walls or buildings encroach or project on said premises, and no power lines cross this property except as shown hereon.

7-F-67

35910

R. B. Bruce  
R. B. Bruce, SLS #1952



CAROLINA SURVEYING CO.  
112 Manly St.  
100 A4 Greenville, S. C.

7 5 15 MIN 4 E

210 @ 46

276 1 0 1