

GREENVILLE, S.C.
 JAN 28 2 35 PM '80
 JOHN W. WATERSLEY
 R.H.C.

SECTION #3
 BURGESS HILLS SUBDIVISION

J. G. HAYES

J. VERNE SMITH

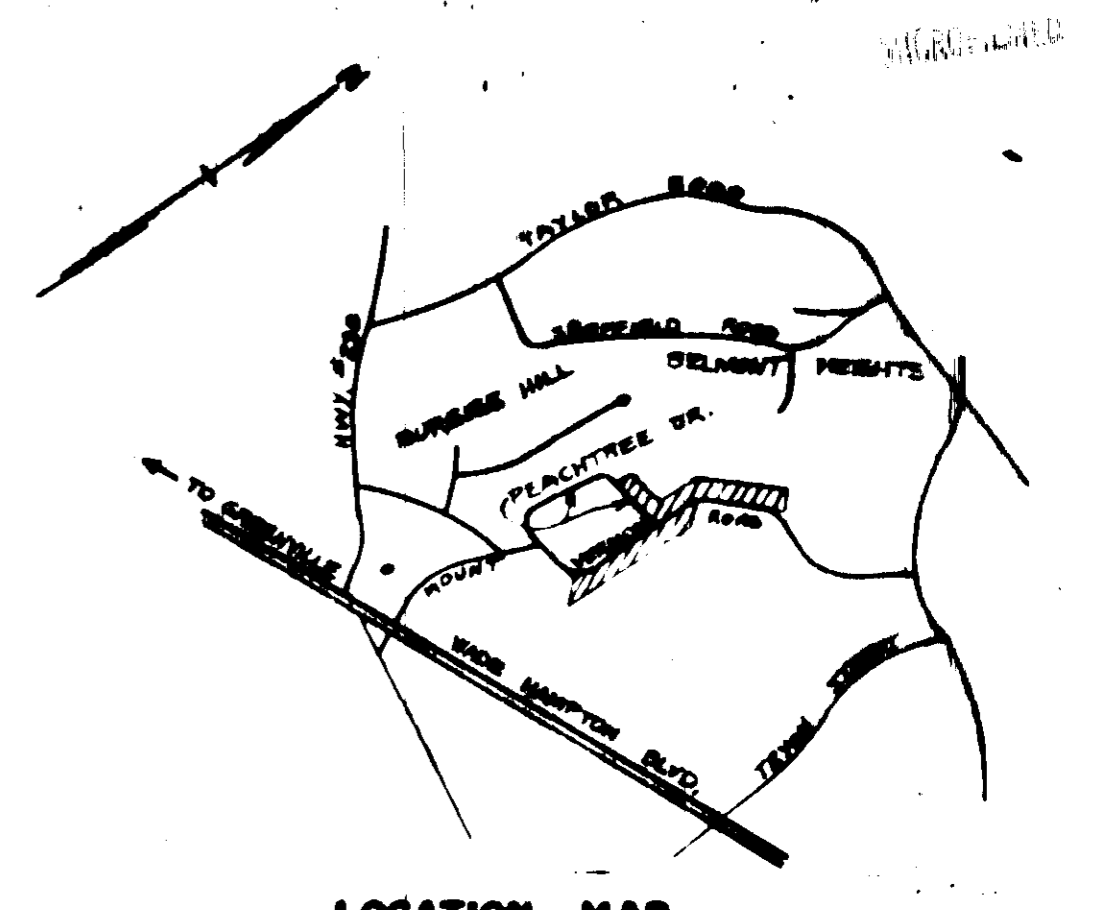
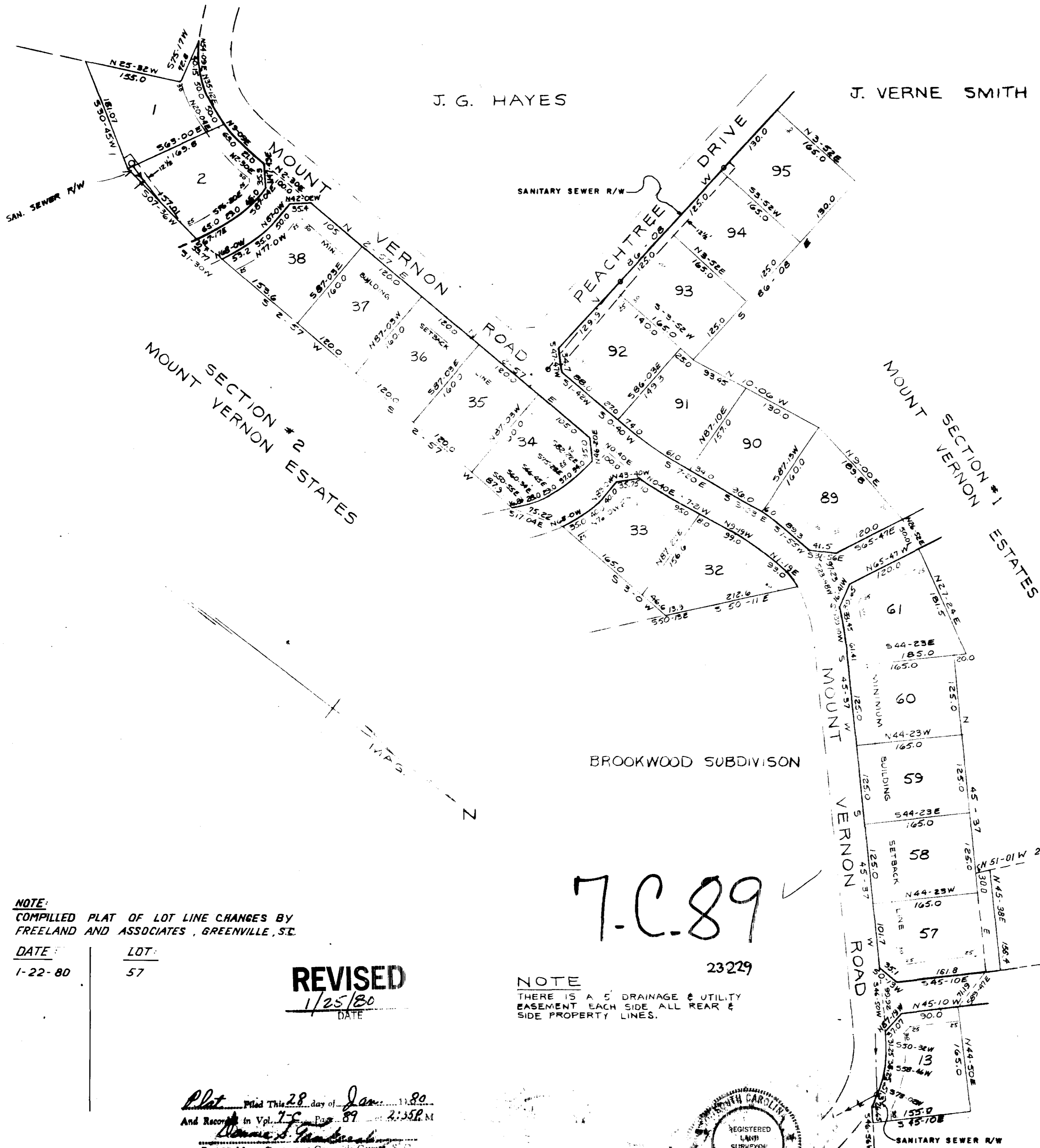

LOCATION MAP

WARRANT OF OWNERSHIP AND INDICATION

I, the undersigned, being duly qualified, do hereby certify that the above described plat has been found to comply with the Subdivision Regulations for Greenville County, with the exception of such variances, if any, as are noted in the minutes of the Greenville County Planning Commission of Greenville County, South Carolina, and that it has been approved for recording in the office of the County Register of Mimeo Conveyance.

J. Verne Smith
 Surveyor

CERTIFICATE OF APPROVAL

I hereby certify that the subdivision plat shown herein has been found to comply with the Subdivision Regulations for Greenville County, with the exception of such variances, if any, as are noted in the minutes of the Greenville County Planning Commission of Greenville County, South Carolina, and that it has been approved for recording in the office of the County Register of Mimeo Conveyance.

3-23 1973 *J. Verne Smith*
 Surveyor

CERTIFICATE OF APPROVAL FOR RECORDING

"I hereby certify that the subdivision plat shown herein has been found to comply with the Subdivision Regulations for Greenville County, with the exception of such variances, if any, as are noted in the minutes of the Greenville County Planning Commission of Greenville County, South Carolina, and that it has been approved for recording in the office of the County Register of Mimeo Conveyance."

3-23 1973 *J. Verne Smith*
 Surveyor

REVISED
 1/25/80
 DATE

73-116

MOUNT VERNON ESTATES
 PORTIONS OF SECTIONS 1 & 2

THREATT-MAXWELL ENTERPRISES, OWNER
 PIEDMONT ENGINEERS & ARCHITECTS, SURVEYOR

NO. OF ACRES 11.174 MILES OF NEW ROADS 0

NO. OF LOTS 22 DATE 11-28-78

ERROR OF CLOSURE 1/3000+

SCALE 1" = 100'

NOTE:
 COMPILED PLAT OF LOT LINE CHANGES BY
 FREELAND AND ASSOCIATES, GREENVILLE, S.C.

DATE 1-22-80 LOT 57

REVISED
 1/25/80
 DATE

NOTE
 THERE IS A 5' DRAINAGE & UTILITY
 EASEMENT EACH SIDE ALL REAR &
 SIDE PROPERTY LINES.

7-C-89

23229

Plat filed This 28 day of Jan 1980
 And Recorded in Vpl. 7-f Page 89 2:35P.M.
John W. Watersley
 Register Mimeo Conveyance Greenville County, S.C.



RECORDING FEE
 191 5.00