

FILED
GREENVILLE CO. S.C.

MAR 9 3 14 PM '79

FIRST FLOOR

LEWIS VILLAGE HORIZONTAL PROPERTY REGIME

GREENVILLE COUNTY

GREENVILLE, SOUTH CAROLINA

Scale 1" = 40' February, 1979

DALTON & NEVES CO., ENGINEERS

121 MANLY STREET

GREENVILLE, S. C.

The undersigned certifies that the boundary for the property was drawn from an actual survey dated February, 1979 made by me and that the courses and distances are true and correct, that the building and improvements located thereon are accurately located, that the building and improvements do not encroach or project over the boundary lines, except encroachment of garage as shown hereon.

R. W. [Signature]
S.C. Reg. No. 916

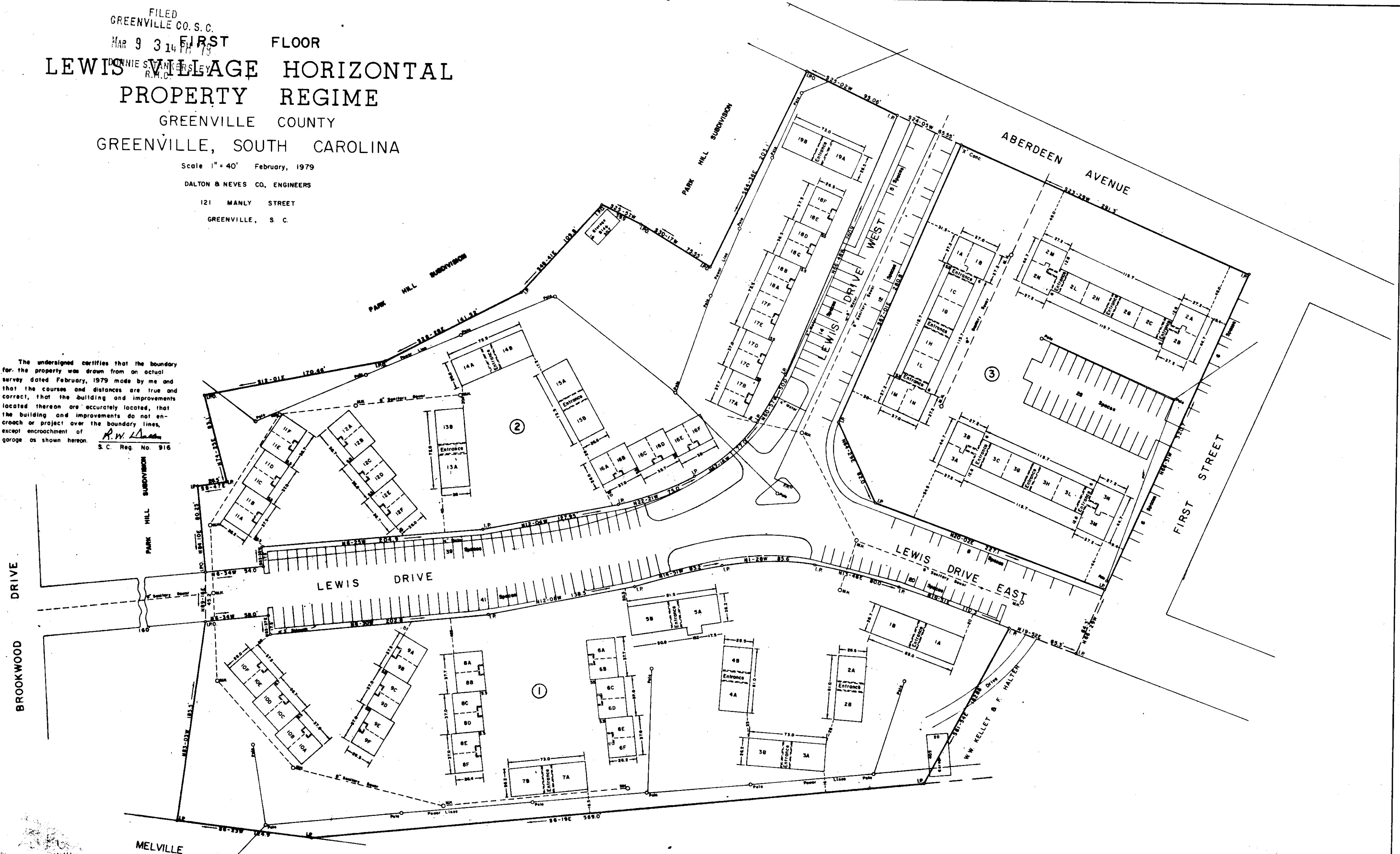

BROOKWOOD DRIVE

MELVILLE AVENUE

ABERDEEN AVENUE

FIRST STREET

LEWIS DRIVE

LEWIS DRIVE EAST

LEGEND

1. This plot plan shows location of Buildings 1 through 19 and through 3 (Plaza) containing a total of 142 units.
2. The additional sheets of this Exhibit B show typical floor plans for the units, their location in each building, and typical front building elevations.
3. Each unit consists of the space bounded by the undercoated and/or unfinished surfaces of the perimeter walls, floors and ceilings.
4. All interior angles in unit are 90° unless otherwise noted.
5. Common Elements: - - - - -
6. General Common Area: = = = = =



AREA ① = 3.25 ACRES
 AREA ② = 2.78 ACRES
 AREA ③ = 2.15 ACRES

TOTAL 8.18 ACRES
 GCTO 3 MAR 9 1979 060

THIS PLOT IS NOT A SUBDIVISION
 AS DEFINED BY THE GREENVILLE
 COUNTY SUBDIVISION REGULATIONS.

3/9/79 *[Signature]*
 Greenville County Planning Commission

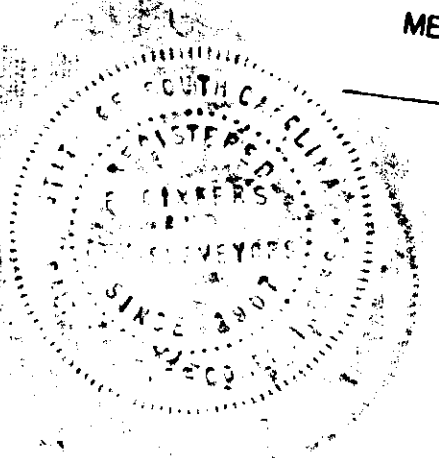

25883
16-V-56

UNRECORDED
3.00CI