

MICROFILMED

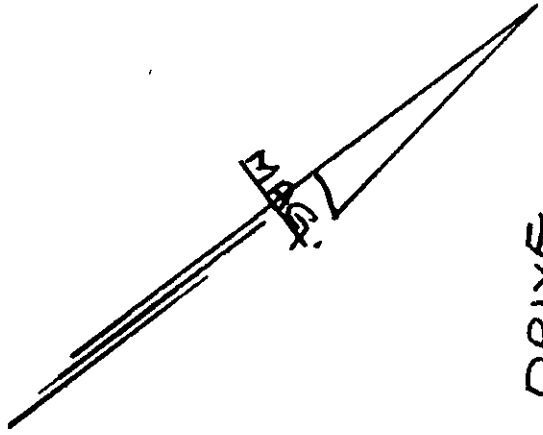

FILED
GREENVILLE CO. S. C.
JUN 24 2 49 PM '76
DONNIE S. TANKERSLEY
R.M.C.

BROOKWAY DRIVE

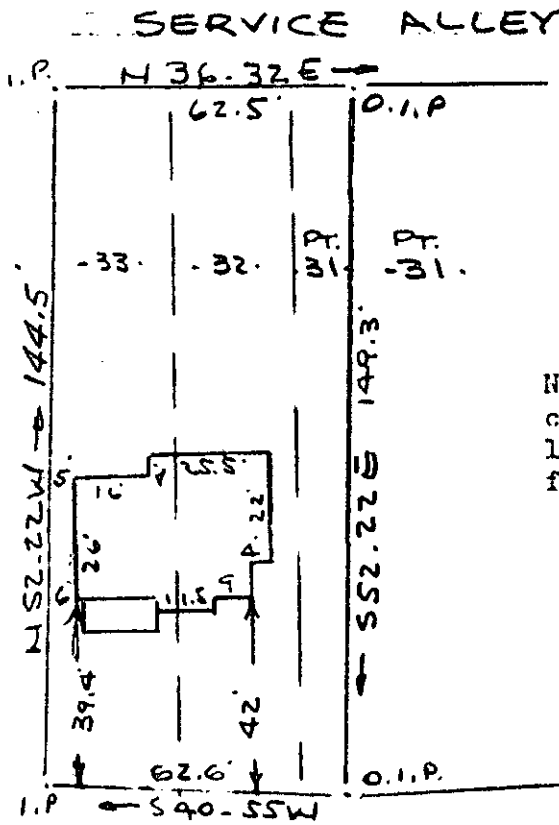

Note: This is to certify that this lot is not in a flood area.

GROVE ROAD
WATER & SEWER IN ST R/W.

PROPERTY OF
ROBERT C. HENDERSON & GAIL M. HENDERSON
GREENVILLE, S.C.
SCALE 1" = 40 16 JUNE 1976

This is to certify that on the 16th day of June, 1976, I surveyed the property shown on this plat, being known as lot 32, 33 and part of 31 block "A" of Grove Park and recorded in the RMC Office Greenville County, S. C., in Plat Book "J" at Page 68 and 69, and also being known as property of Robert C. Henderson and Gail M. Henderson recorded in Plat Book 5-U at page 61; and that the property lines, walls and buildings are as shown hereon, and that the walls and buildings located on said lot do not encroach or project on adjacent street or property, and that no adjacent walls or buildings encroach or project on said premises, and no power lines cross this property except as shown hereon.

R. B. Bruce
R. B. Bruce, RLS #1952

CAROLINA SURVEYING CO. 33682
112 Manly St.
Greenville, S. C.

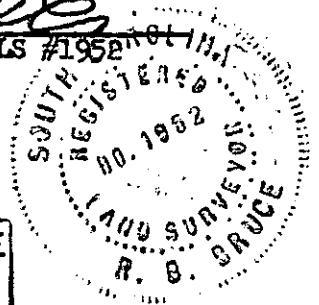

RECORDING FEE
PAID \$ 1.00

5-U-61