

PROPERTY OF  
**PAULINE J. CORNELL ET. AL.**  
 TRAVELERS REST GREENVILLE CO.  
 SOUTH CAROLINA  
 FEBRUARY 4, 1976

W. R. WILLIAMS, JR. ENGR. / SURVEYOR 3970  
 18 SOUTH MAIN STREET  
 TRAVELERS REST, S. C.

NOTE:  
 SEE PLAT OF PROPERTY OF  
 MRS. CARRIE S. HOLTZCLAW,  
 BY J. MAC RICHARDSON, DATED  
 SEPT 1, 1953. A MAP OF LOVE  
 ESTATES, BY W. J. RIDDLE,  
 DATED APRIL, 1938

SCALE 1" = 80'

FILED  
 GREENVILLE CO. S. C.  
 Dec 23 10 23 AM '76  
 DONNIE S. TANKERSLEY  
 R.H.C.

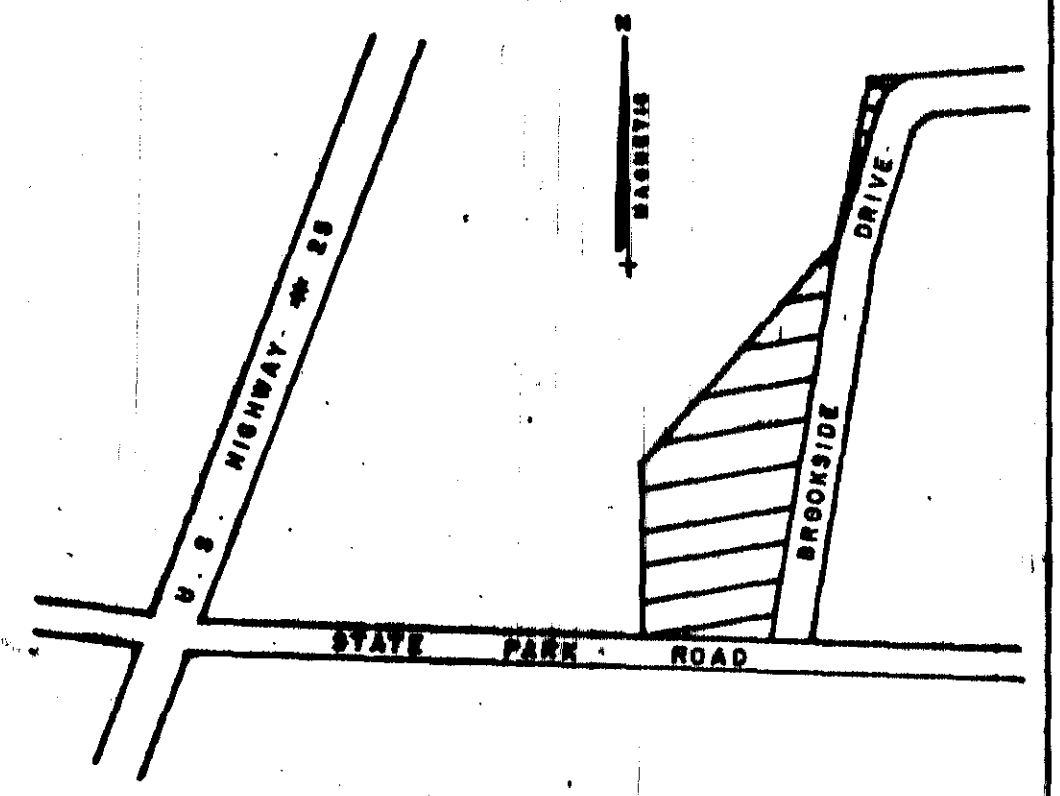

**FINAL PLAT**

**CERTIFICATE OF OWNERSHIP AND DEDICATION**

"The undersigned hereby acknowledge that I am (we are) the owner(s) of the property shown and described herein and that I (we) hereby accept this plan of subdivision with my (our) free consent and that I (we) establish the minimum building restriction lines, and hereby dedicate to public use as roads, streets, and easements, forever all areas so shown or indicated on said plat.

2 / 4 / 76 Signed *Narda H. Lytle*  
 1 / 1 / 76 Signed *Pauline J. Cornell*  
 1 / 1 / 76 Signed *Frances H. Becken*  
 1 / 1 / 76 Signed *Minnie Lee Holtzclaw*

**CERTIFICATE OF ACCURACY**

W. R. WILLIAMS, JR. certify that this plat was drawn by me (or under my supervision) (an actual survey made under my supervision) from an actual survey made by me (or under my supervision) (from an actual survey made by me) (from a description recorded in Book \_\_\_\_\_ Page \_\_\_\_\_ et al.) (other); that the error of closure as calculated by latitudes and departures is \_\_\_\_\_ that the boundaries not surveyed are shown as broken lines plotted from information found in Book \_\_\_\_\_ Page \_\_\_\_\_; that this plat was prepared in accordance with the Greenville County Subdivision Regulations as adopted.

2 / 4 / 76 DATE  
 W. R. WILLIAMS, JR.  
 LICENSED ENGINEER OR REGISTERED SURVEYOR  
 S. C. Registration No. 3970

**CERTIFICATE OF APPROVAL FOR RECORDING**

"I hereby certify that the subdivision plat shown herein has been found to comply with the Subdivision Regulations for Greenville County, with the exception of such variances, if any, as are noted in the minutes of the Greenville County Planning Commission of Greenville County, South Carolina, and that it has been approved for recording in the office of the County Register of Mens Conveyance."

12/21/76 DATE  
 J. Coleman House  
 DIRECTOR OF PLANNING  
 GREENVILLE COUNTY PLANNING COMMISSION

NOTE:  
 LOT 1A WILL BE TRANSFERRED  
 AND BECOME PART OF LOTS 1 & 2.  
 LOT 3A WILL BE TRANSFERRED  
 AND BECOME PART OF LOTS 3 & 4.  
 LOT 5A WILL BE TRANSFERRED  
 AND BECOME PART OF LOTS 5 & 6.  
 LOT 7A WILL BE TRANSFERRED  
 AND BECOME PART OF LOTS 7 & 8.  
 8A ERROR IN ORIGINAL SURVEY.

**FILE NUMBER**  
**76-155**  
**SUMMARY PLAT**

PROPERTY OF  
**PAULINE J. CORNELL ET. AL.**

PAULINE J. CORNELL ET. AL. OWNER  
 W. R. WILLIAMS, JR. SURVEYOR

NO. OF ACRES: 1.64

NO. OF LOTS: 4 DATE: 2/4/76

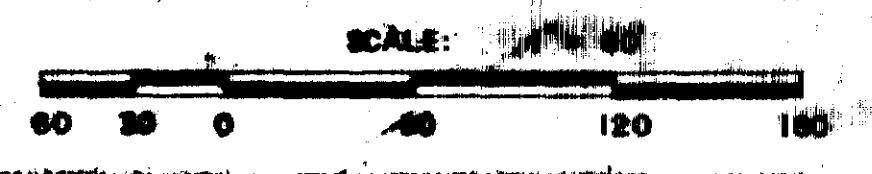

16991  
 15-P-65 DEC 23 1976

Plat Filed This 23 day of Dec 1976  
 And Recorded in Vol. 5 P. Page 65 at 10:13 AM  
 Donnie S. Tankersley  
 Register Mens Conveyance Greenville County, S. C.