

MICROFILMED

DORTHY B. BURTON

N 6-10 W 199.4 →

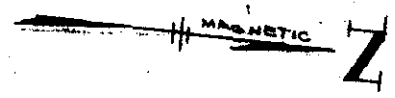
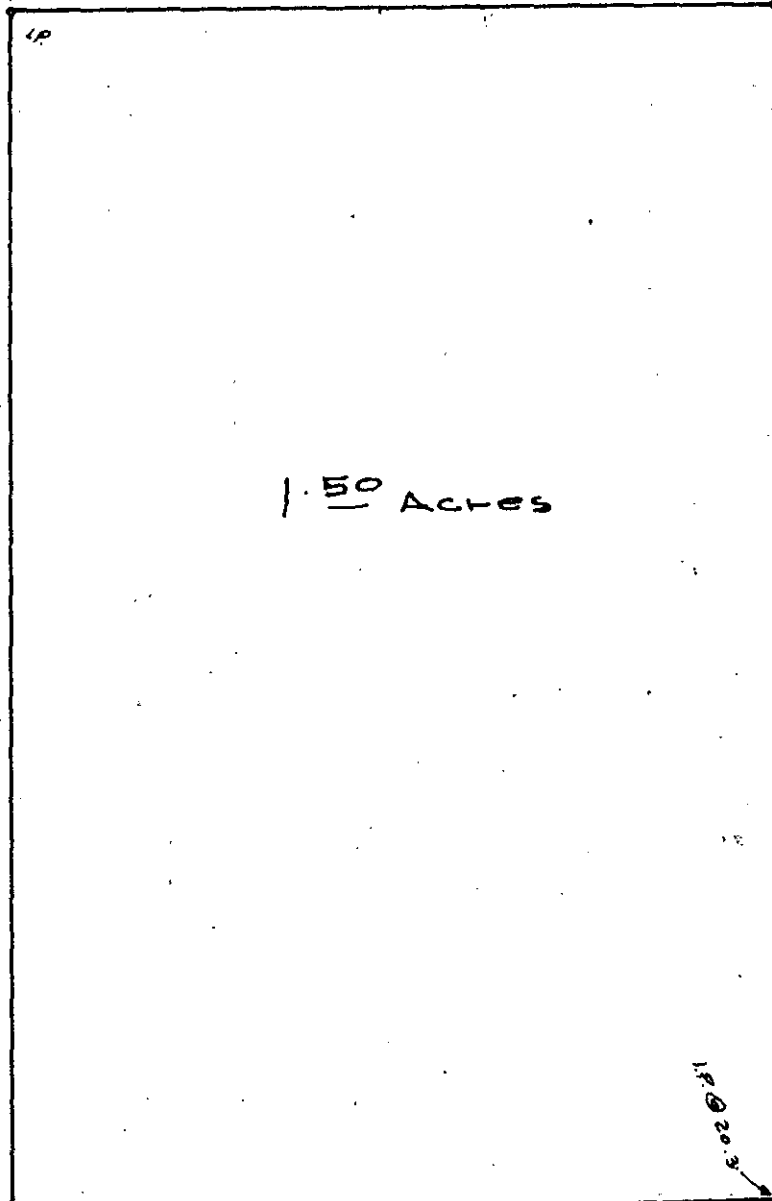

MARION F. BRAZEAL

S 83-50 W 335.4 RD

N 83-50 E 322.9 RD

DORTHY B. BURTON

1.50 Acres

FILED
 GREENVILLE CO. S.C.
 JUN 12 1 02 PM '75
 DONNIE S. TANKERSLEY
 R.M.C.

19.0 20.3

648.4 to I.P. & R.L. →

200

S 9-38 E

SPIKE

PINSON ROAD

PROPERTY OF

JAMES E. BRAZEAL

GREENVILLE CO. S.C.

SCALE 1" = 50'

MAY 31, 1975

JUN 12 1975

5M-62

RECORDING FEE
 PAID \$ 1.00

29358