

S79-28W-
78.0

FILED
GREENVILLE CO. S.C.
AUG 4 1 41 PM '75
DONNIE S. TANKERSLEY
R.M.C.

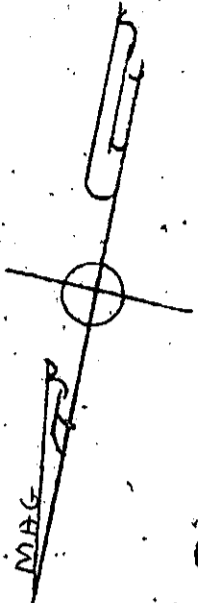

S10-17E
150

S41-01N
150

(NEW BUNCOMBE)
POINSCITE HWY

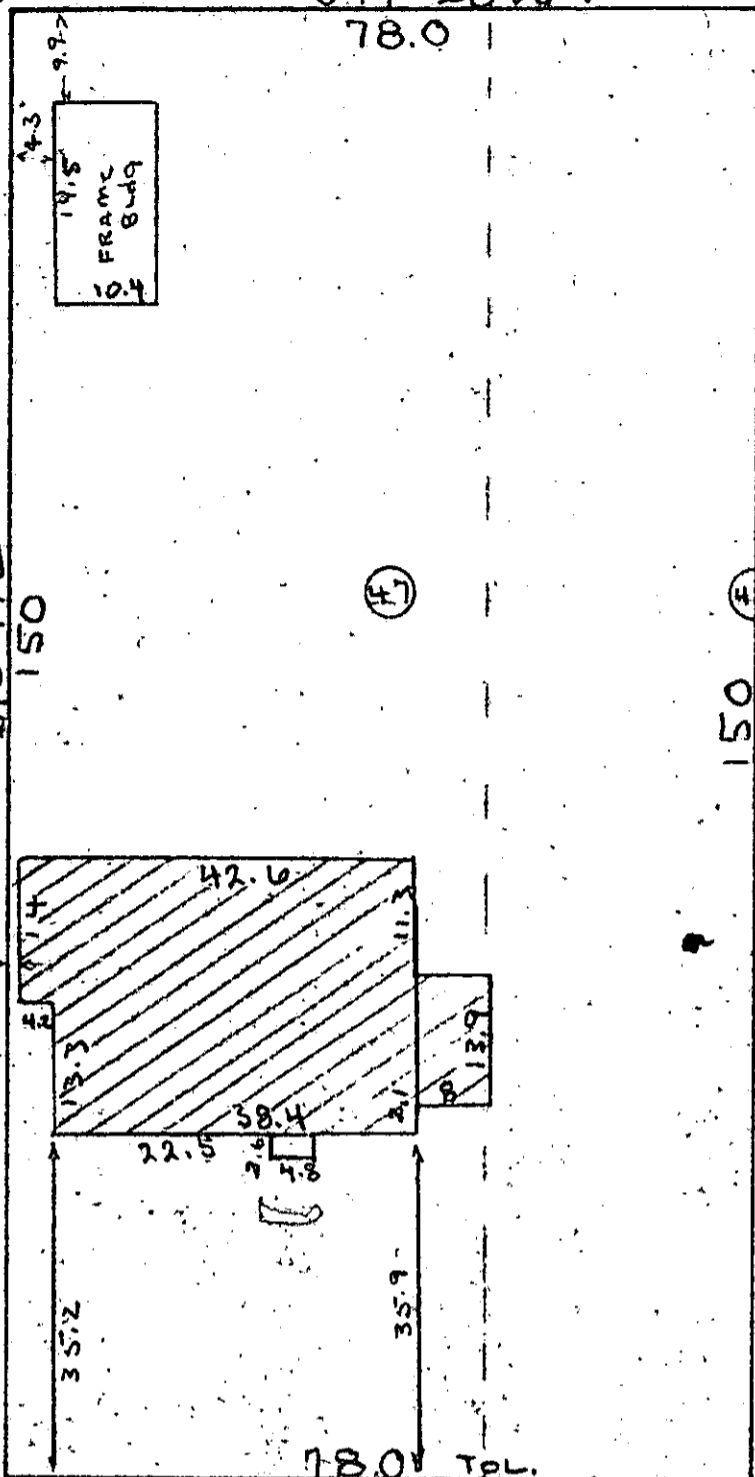

410

180 TOL.
-N79-28E

ROGERS AVE.

PROPERTY OF

PAUL ARNOLD PITTMAN

NEAR THE CITY OF GREENVILLE

GREENVILLE COUNTY, S.C.

WEBB SURVEYING & MAPPING, C.A.

SCALE 1"=20'

July 25, 1975

I hereby certify that on July 25, 1975 I surveyed lot 47 and a portion of lot 46 according to a plat of a subdivision of Perry Property recorded in plat book I on page 33 in the R.M.C. Office of Greenville County; and that the property lines, buildings, and walls are as shown hereon, that no walls or buildings encroach on adjacent streets or property, and no buildings encroach or project on these premises.

Charles F. Webb R.L.S.

3067

56-66

RECORDING FEE
PAID \$ 2.00

