

SURVEY FOR
JAMES E. DURHAM
NEAR GREENVILLE, S.C.
SCALE 1" = 60' 18 MAR 1974

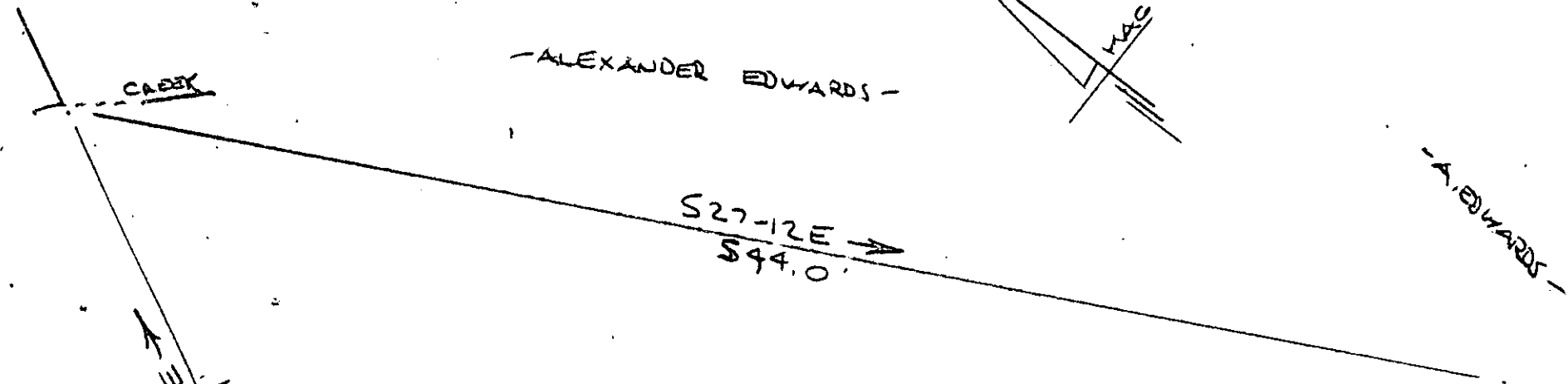

FILED
GREENVILLE CO. S.C.
MAY 8 4 39 PM '74
DONNIE S. TANKERSLEY
R.M.C.

N 27-00 E
642.2'

S 27-12 E
544.0'

-ALEXANDER EDWARDS-

-A. EDWARDS-

N 12-14 S
125'

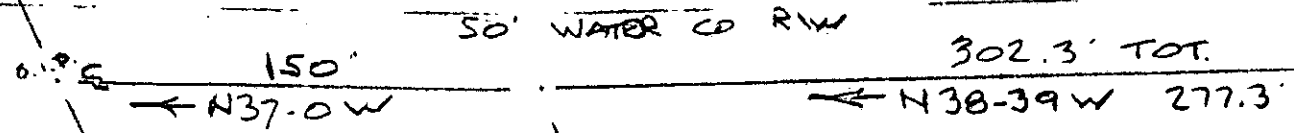

30 FT. DRIVE TO

-STONE-

MAY 8 1974

RB#
1952

CAROLINA SURVEYING CO
112 MAIN ST.
GREENVILLE, S.C.

3 28258

25'
MICROFILMED

RECORDING FEE
PAID \$ 1.00

56-42

NB