

RUSSELL C. ASHMORE SR.

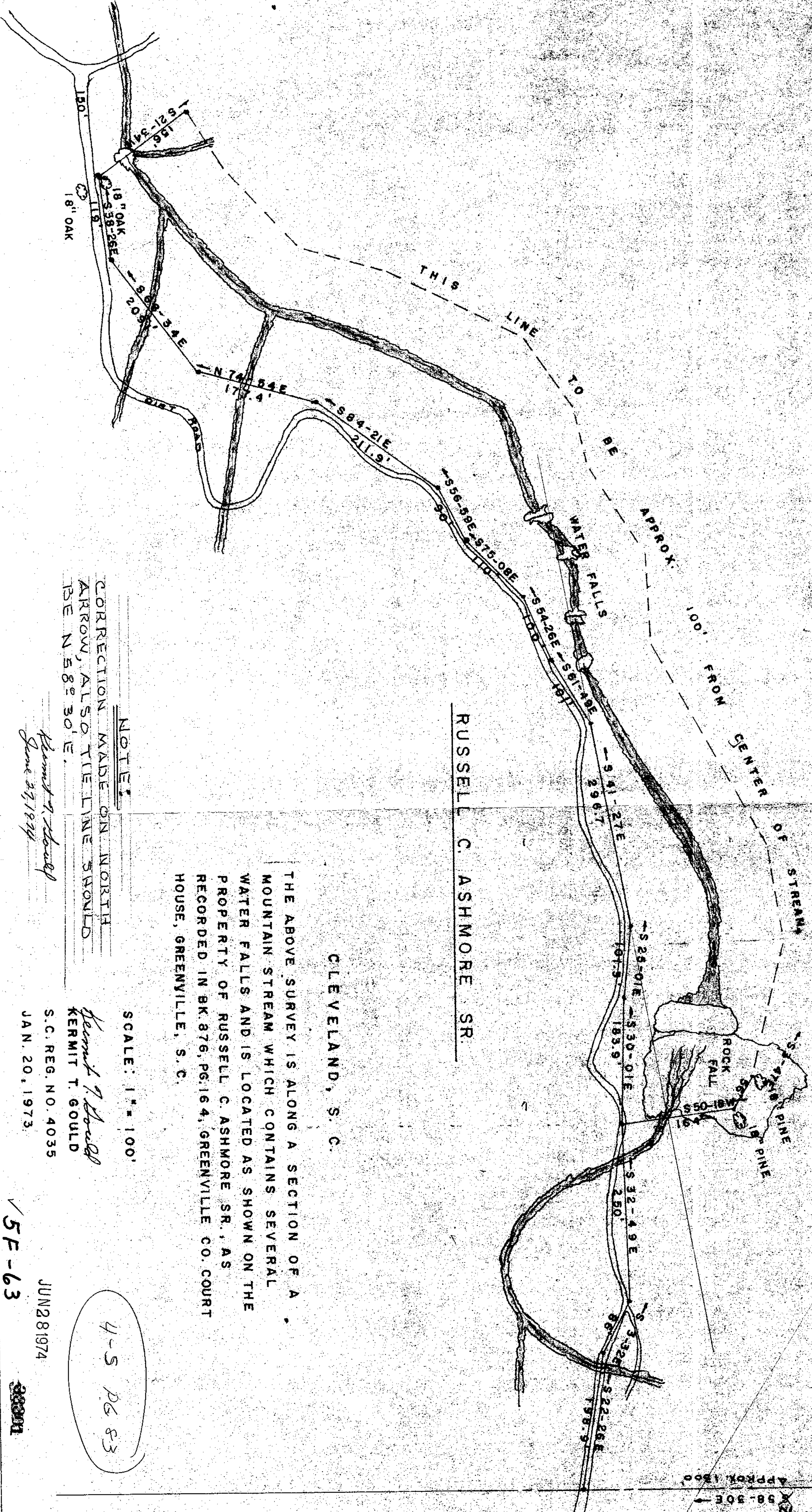

RUSSELL C. ASHMORE SR.

CLEVELAND, S. C.

THE ABOVE SURVEY IS ALONG A SECTION OF A MOUNTAIN STREAM WHICH CONTAINS SEVERAL WATER FALLS AND IS LOCATED AS SHOWN ON THE PROPERTY OF RUSSELL C. ASHMORE SR., AS RECORDED IN BK. 876, PG. 164, GREENVILLE CO. COURT HOUSE, GREENVILLE, S. C.

SCALE: 1" = 100'

NOTE:
CORRECTION MADE ON NORTH ARROW, ALSO THE LINE SHOULD BE N 58° 30' E.

Henry T. Gould
June 27, 1974

Henry T. Gould
KERRIT T. GOULD
S. C. REG. NO. 4035
JAN. 20, 1973.

4-5 PG 83

JUN 28 1974

5F-63

RECORDING FEE
\$302

FILED
GREENVILLE CO. S. C.
JUN 28 9 41 AM 1974
DORRIS S. YANKERSLEY
R. M. C.

Rock 7 N 48.30 W

DIST. 30'

APPROX. 150'