

RECORDING FEE

PAID \$ 1.00

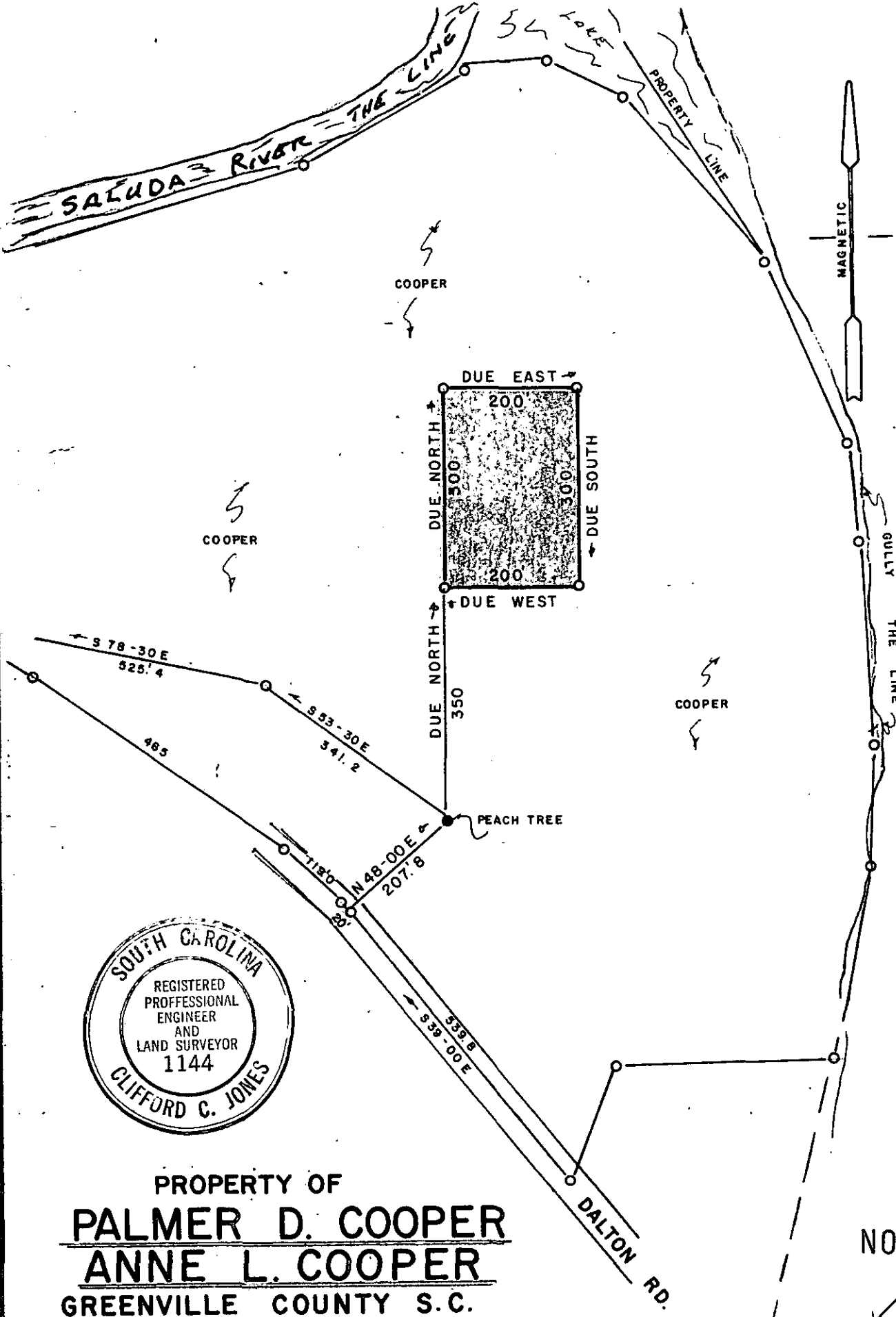

FILED
 GREENVILLE CO. S. C.
 NOV 13 4 41 PM '72
 ELIZABETH RIDDLE
 R.M.C.

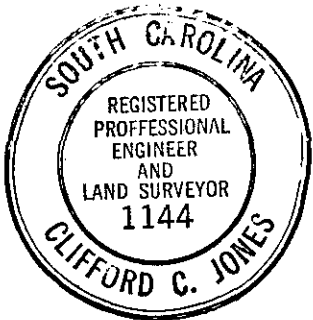

PROPERTY OF
PALMER D. COOPER
ANNE L. COOPER
 GREENVILLE COUNTY S.C.
 SCALE 1"=200' NOV 13, 1972

NOV 13 1972

14236

424-51