

(48)

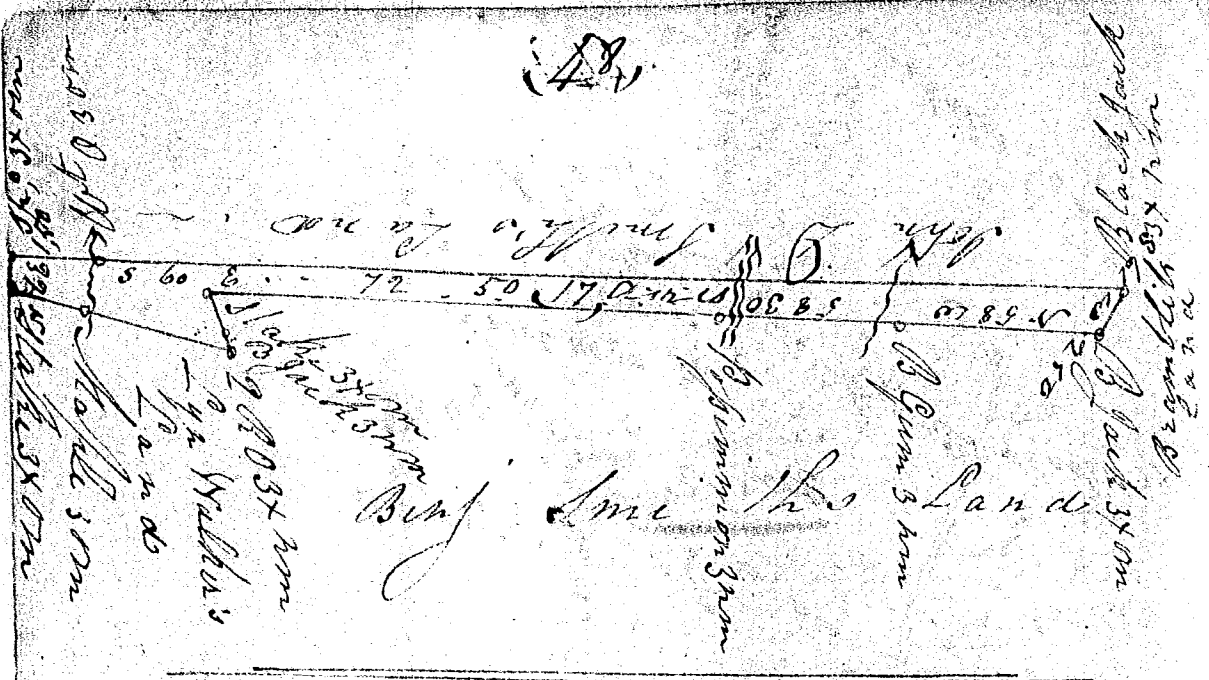

South Carolina

Pursuant to a warrant from John Young Esq. Commt. of Loos for the District of Greenville bearing date the 3rd day of Jan'y 1821. I have caused to be ad-measured and laid out unto John D Smith a tract of Seventeen acres of land on Branches of Rock Creek waters of Enoree River, Bounded by Benj Smiths line running NW & SW, Walkers line NW by said Smiths line SE, by Bramblets line SW and has such forbes and marks, Bulings & Boundings as the above Plat represents, Survey'd and Certified this 13th day of Jan'y 1821 — A. Griffith D.S.

Recorded the 27th of June 1821

John Young Ck

handed to self