

and shown by a scale of  
 twenty five feet

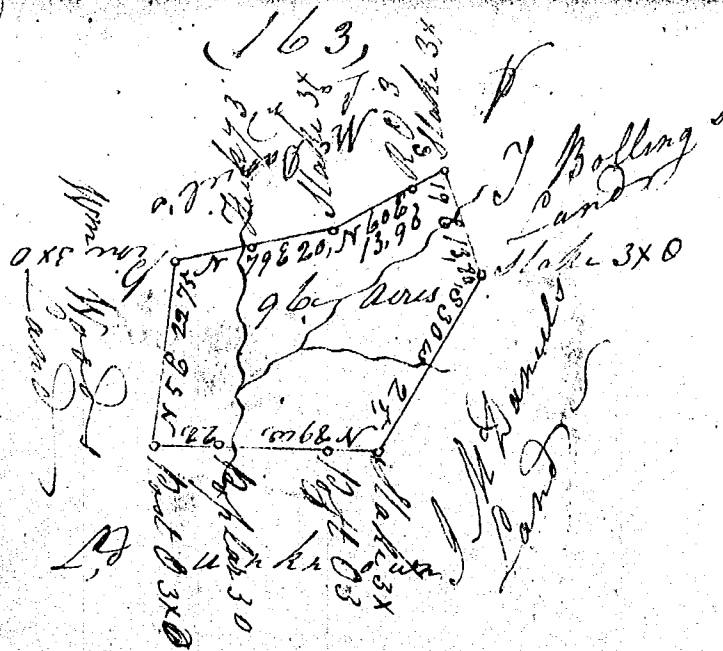

State of S. Carolina

Pursuant to a warrant from John Young Esqr Commr of Locations in the District of Greenville, dated the 9th day of Jan<sup>y</sup> 1819, I have, admeasured and laid out unto Redden Hall a tract of Land containing Ninety six acres, situate in the said District on the branches of Mountain Creek waters of Saluda River. Bounded by lines running N. E. by land survey for Archabal McDaniel, S. E. by J. Bolling S. W. & N. W. by John McDaniel & Land unknown, N. O. by land survey for Wm Wood And with such shape form and marks as the above Plat represents, Surveyed this 11th day of Jan<sup>y</sup> 1819 by Ben Arnold D<sup>s</sup>

Recorded the 14th day of Jan<sup>y</sup> 1819 by  
 John Young, Comm<sup>r</sup> Locating  
 handed to Col Arnold