

South Carolina

92

pursuant to a warrant from Wm. G. Thomas Commissioner of Locations in the district of Greenville dated the 14th Day of February 1814 I have admeasured and laid out into John Level a tract of land containing fifty acres situate in the said

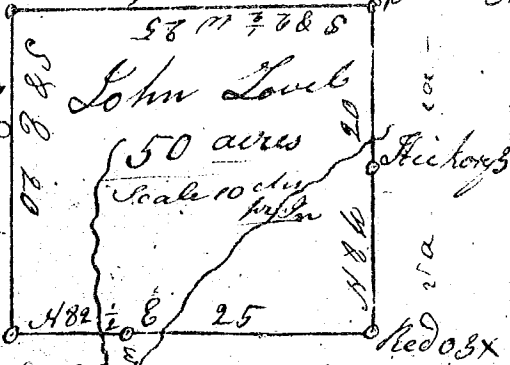

District on branches of the Devils fork Creek Waters of the Middle fork of Saluda River bounded by a line running N 82 1/2 E by land Survey for Jeremiah Nisbit and on all other sides by Vacant land & hath such form & marks as the above plat represents, Surveyed the 5th Day of Feb 1814

Recorded the 6th of August 1814 W. H. Cooke D.S.

Chain Carriers
Luke Williams
Mark Williams

South Carolina
pursuant to a warrant from Wm. G. Thomas Commissioner of Locations for the District of Greenville dated the 14th Day of February 1814, I have admeasured and laid out into Luke Williams a tract of land containing forty six acres situate in the said District on branches of Gap Creek & fall Creek waters of the Middle fork of Saluda River bounded by a line running N 44 1/2 W by Joseph Williams Land & on all other sides by Vacant land & hath such form & marks as the above plat represents Surveyed the 16th Day of February 1814

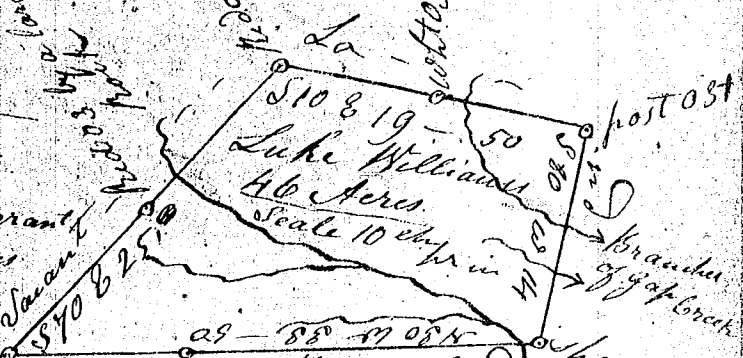

Recorded the 6th Day of August 1814

W. H. Cooke D.S.