

South Carolina  
Greenville Dist.

Pursuant to a  
warrant from Com<sup>d</sup>. Thomas

(68)

Esq<sup>r</sup>. Com<sup>d</sup>. Thos. dated the 6<sup>th</sup> day of  
Aug<sup>r</sup>. 1811. I have measured & laid  
out a tract of Thirty two acres  
of land unto John Arva  
Smith, in the district  
aforesaid, & on both sides  
of a small branch of  
Mush creek the waters

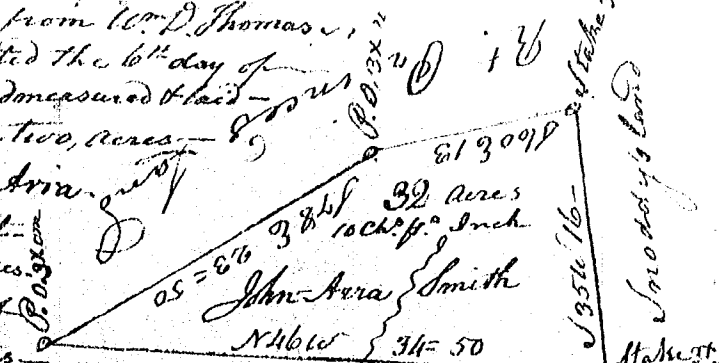

of Tigger River - Bounded - Archibald  
to the NW on land granted to Smoody, to the S. & SW by lands  
granted to Robert Prince, to the NE by Archibald Taylor's land  
& hath such shape form & marches as the above plat represents.

Survey'd the 7<sup>th</sup> day of August 1811  
Recorded this 29<sup>th</sup> day of Oct. 1811  
John Young Del<sup>y</sup>

South Carolina

Pursuant to a warrant

from Com<sup>d</sup>. Thomas Com<sup>d</sup>. of  
Locations for Greenville District  
dated the 8<sup>th</sup> day of Nov<sup>r</sup>. 1811  
I have measured & laid out

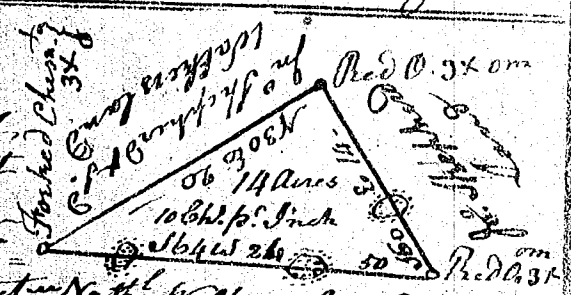

unto John Shepherd, a tract  
of Fourteen acres of land, situate in Greenville District the  
State aforesaid on the SE side of the SE fork of Rocky  
creek, Bounding by lines running, SW. by Nathaniel  
Walther's land, N. E. & N. E. by said John Shepherd's land. & said  
Nath<sup>l</sup>. Walther's land, & hath shape, marks, buttings & bounding  
as the above plat represents. Surv. this 20<sup>th</sup> Nov<sup>r</sup>. 1811.

Recorded 21<sup>st</sup> Nov<sup>r</sup>. 1811 - Del<sup>y</sup>. B. Smith  
Jas. Kilgore Del<sup>y</sup>

South Carolina - Pursuant

to a warrant from Com<sup>d</sup>. Thomas  
Com<sup>d</sup>. Locations for Greenville  
District, dated the 1<sup>st</sup> Nov<sup>r</sup>. 1811  
I have measured & laid out

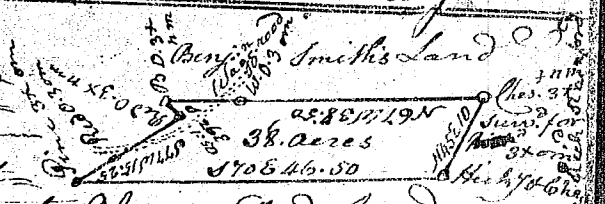

unto Benjamin Smith, a tract  
of thirty eight acres of land, situate in the State & dist<sup>r</sup> aforesaid  
on both sides the wagon road leading from to the Court House  
Bounding by lines running S. E. by James Wofford's land N. E. by land laid out for  
Richard Stanford S. W. N. E. & S. E. by Ben<sup>am</sup>. Smith's & Beal's lands  
& hath such marks buttings & bounding as the above plat represents.

Surv<sup>d</sup> the 20<sup>th</sup> day of Nov<sup>r</sup>. 1811  
Recorded 21<sup>st</sup> Nov<sup>r</sup>. 1811, Del<sup>y</sup>. B. Smith  
Jas. Kilgore Del<sup>y</sup>