

South Carolina

(59)

Pursuant to a warrant
 from Wm D. Thomas Com. Gen.
 in Greenville District dated the
 20th Nov. 1809 I have admeas.
 & laid out unto John Cochran
 a tract of Twenty one acres and
 five Chain of land. Situate in
 said district on a branch the
 waters of S. Paulet River. Bounded by a line running
 S E 34° $45'$ E by land belonging to said Cochran the other
 side vacant & hath seth form & marks as the above
 plat represents. Surveyed this 29th Nov. 1809 by me
 Recorded the 15th Jan'y 1810

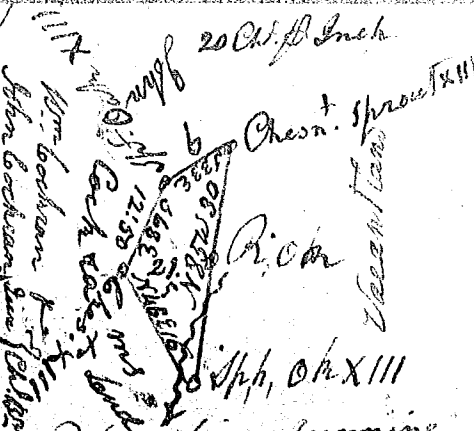

John Whitten S. D.



Pursuant to a Warrant from
 W. D. Thomas Esq. C. G. dated the 25th May
 1810, I have admeasured & laid out unto
 Wm D. Coole a tract of Three hundred & seventy two
 acres of land, Situate in Greenville District on the
 head branches of beaverdam creek waters of Tyger river
 & two small branches of Enoree River & Buncombe
 road, bounded to the N. & W. on said Coole to the
 N. E. by Bin^g Langford's & S. E. by Dan^l Brown's & S. W.
 & has the usual shape, form & marks as the above plat
 represents. Surveyed the 29th May 1810

Recorded the 31st May 1810
 John Young S. D.