

So Carolina

(42)

Pursuant to a warrant from Wm. D. Thomas Esq. in the District of Greenville, S.C. Dated the 6th of Oct. 1807 I have surveyed and laid out unto James Hutson a tract of land containing

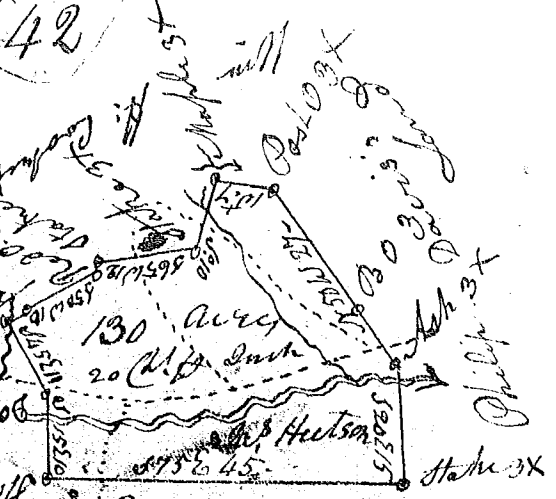

One hundred and thirty acres, situated on the said district, on both sides of the west fork of beaver dam creek waters of the N. fork of Saluda river. Bounded by lines running N. 10. E. by Philip Davis' land S. 10. W. by Wm. Coombs' land, S. 6. E. by Elijah Eyres land & all other sides by vacant land, & hath such form & marks as the above plat represents

Surveyed the 7th Oct. 1807 J. M. Cooper Esq.  
Recorded the 17th Oct. 1807

Pursuant to a warrant from Wm. D. Thomas Esq. in the District of Greenville, S.C. Dated the 23rd Dec. 1807 I have surveyed and laid out unto Wm. F. Downs a



Plantation or tract of land containing 283 acres Situate in Greenville District on a branch of Gildersleepe creek call'd horse pen fork & hath such form & marks & boundaries as the above plat represents

Surveyed 24th Dec. 1807 - John Rodgers Esq.  
Recorded the 30th Jan. 1808 - D. M. Hamilton