

(4)

State of S. Carolina
Pursuant to a
warrant from John
Thomas Esq. C. L. M. D.
dated the 16th Feb^y 1796
I have admeasured & laid
out unto Charles Deuces
a tract of One hundred &
fifty five Acres of Land

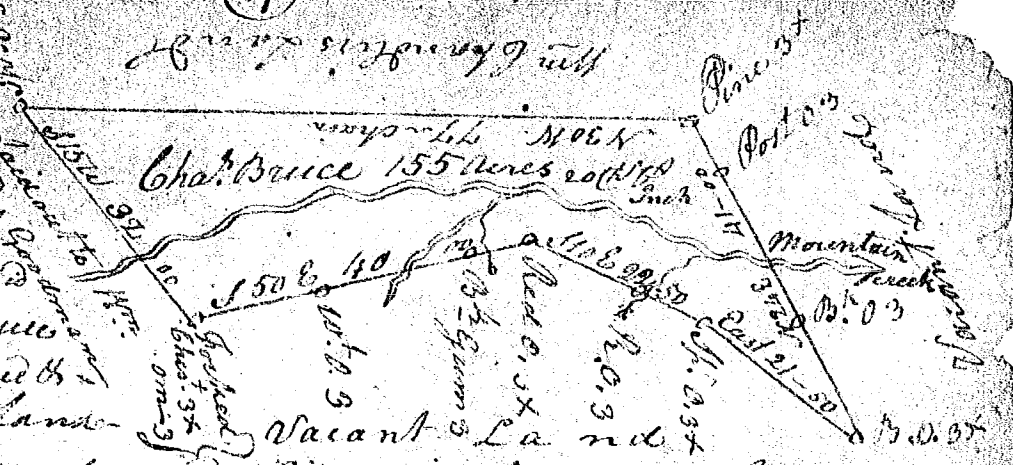

Situate in the State aforesaid & Greenville County on the East side of
Paris Mountain on both sides of Mountain creek Waters of Enoree river
bounded by lines Run by Me by ~~Wm Goodmans land~~ & by
Wm Goodmans land SE
& by Vacant Land NW by Wm Goodmans land & hath such
form & marks as the above plat represents
Recorded this 3rd Feb^y 1804
J. Higgin D.

South Carolina - Pursuant to a warrant from
John Thomas Esq. Com. Elections, Co. 96 District
I have admeasured & laid out unto William
Smith a tract of 29 acres of land situate
in said district on Indian creek Waters of
Enoree River - & hath such bounding form
& marks as the above plat represents

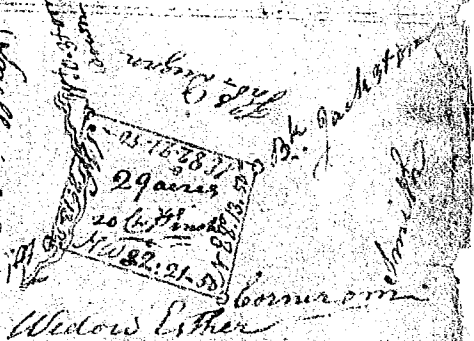

Certified by this 31st day of October 1803
Recorded this 15th of Feb^y 1804
South Carolina Pursuant to a warrant
from John Thomas Esq. C. L. M. D. District
I have admeasured & laid out unto
William Smith a tract of 14 1/2 acres
of land situate in said district
on Indian creek Waters of Enoree river
& hath such form & marks as the above plat
represents. & Certified this 31st October 1803

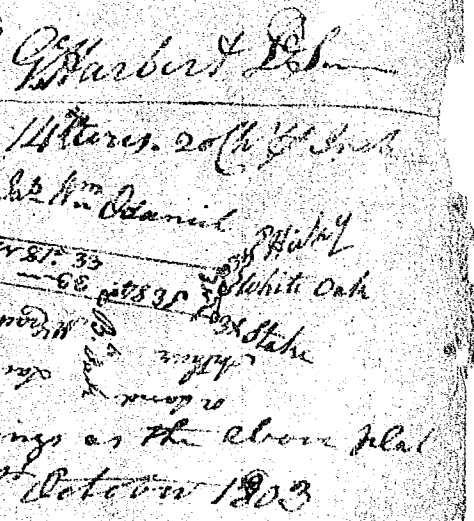

Recorded this 15th Feb^y 1804
J. Higgin D.