

Laid down at 10 Ch^r Pr. Ind^y (1817)

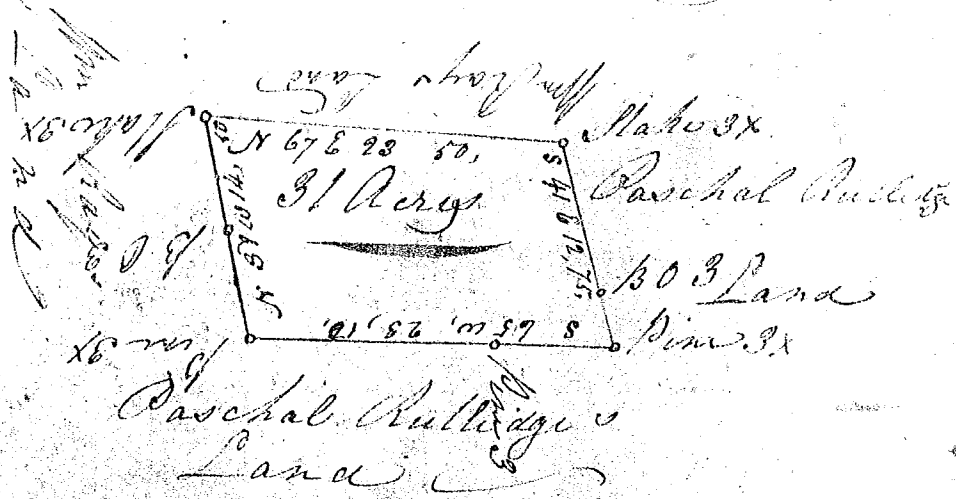

South Carolina }
 Greenville District } Pursuant to a warrant
 from John Young, Esq^r Commissioner of Land
 Office, bearing date the 31st of March 1818.
 I have caused to be admeasured and laid
 out unto Paschal Rutledge a tract of 31
 Acres of Land, lying on the South side of
 Cuddy River, bounded to the N by S. Rutledge
 Land, NW & NE by McRay's Land, and both
 such form & Marks, Sitings & Boundings as
 the above Plat represents.
 Certified by me this 5th of April 1818.
 B. Griffith D. S.

Recorded the 5th day of May 1818.
 handed to self