

S<sup>c</sup> Carolina Pursuant to a (101)

warrant from John Thomas, Comr. of  
 Loc<sup>ys</sup> Dated 29<sup>th</sup> May 1801, I have surveyed  
 for Robert Thomson a tract of sixty acres  
 of land lying on branches of the N side  
 of Thickety Creek in Union District  
 bounded N.W. & N.E. by Luptons land  
 S.E. by customs land & S.W. by the  
 said Robert Thomson, and hath  
 such shape and marks as the  
 above plat represents.

Surveyed 3<sup>rd</sup> June 1801

W<sup>m</sup> Smith Dea  
 Recorded 15<sup>th</sup> Aug<sup>r</sup> 1801.

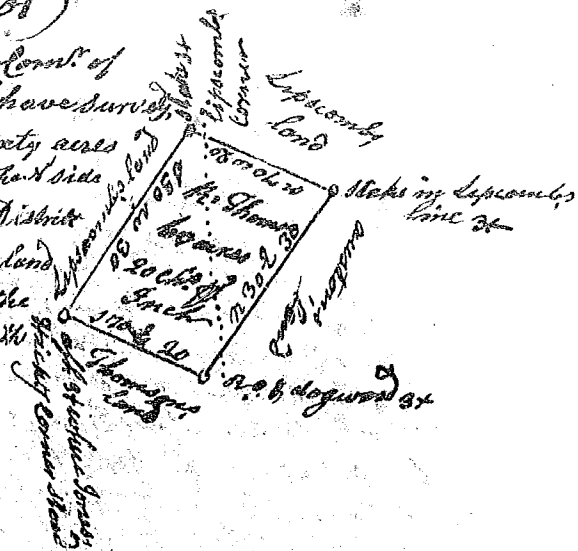

S<sup>c</sup> Carolina Pursuant to a warrant from

John Thomas Esq. Comr. North of Saluda  
 dated the 10<sup>th</sup> of July 1801. I have ad-  
 measured & laid out unto John  
 Robnett a tract of twenty nine  
 acres of land. Situate on the

W side fork of Sugar River in Spartan-  
 burgh District bounded by lines run  
 N.E. & S.W. by the heirs of Joseph Nesbitt  
 Land & by Samuel Nesbitt & hath such form & marks  
 as the above plat represents. Surveyed the 11<sup>th</sup> July 1801.

Recorded 27<sup>th</sup> August 1801.

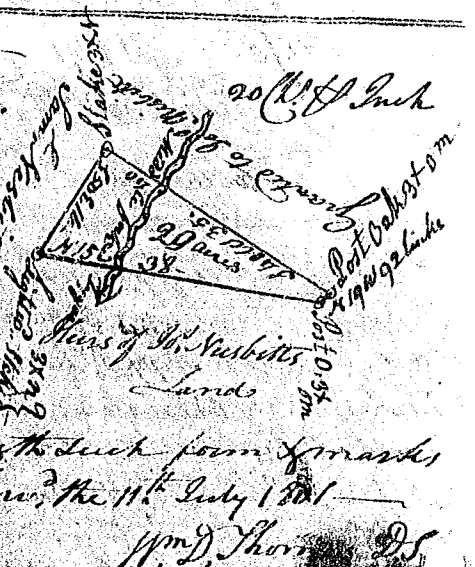

S<sup>c</sup> Carolina Pursuant to a warrant from

John Thomas, Comr. of Loc<sup>ys</sup>  
 I have admeasured and laid out unto  
 John Roland a tract of one hundred  
 and twelve acres of land in Union  
 District on a branch of Raysbourne  
 Creek call<sup>d</sup> Meharg's branch. Bound<sup>d</sup> N.W.  
 & on Charles Gray's land & on Charles  
 Anderson's land, S. on Archibald  
 Meharg's land & on land laid out  
 and hath such shape & mark as  
 the above plat represents.

Recorded 2<sup>nd</sup> July 1801,

