

James Alexander.
500 acres.

Laid Down by a scale of 2 inch = 1 mile

South Carolina / Pursuant to an warrant from John Thomas Esq -
Dated 25th April 1799 I have admeasured and laid out unto
James Alexander a tract of five hundred acres of land in greenow
ville County on the N. side of Needy River on some small
branches of Cripple Creek waters of said of said River, bounding on
lines running N.E. by aquila Brascher and Capt. Napsels land, S.E.
by land survey for James Lynn, S.W. S.E. by land survey for James
Habit, S.W. by James Alexander's own land N.W. by James Harrison's
land all other sides vacant, - and hath such shape & marks as
the above Plat represents, Surveyed 14th June 1799
Recorded 22nd June 1799. - James Hillgore Esq.

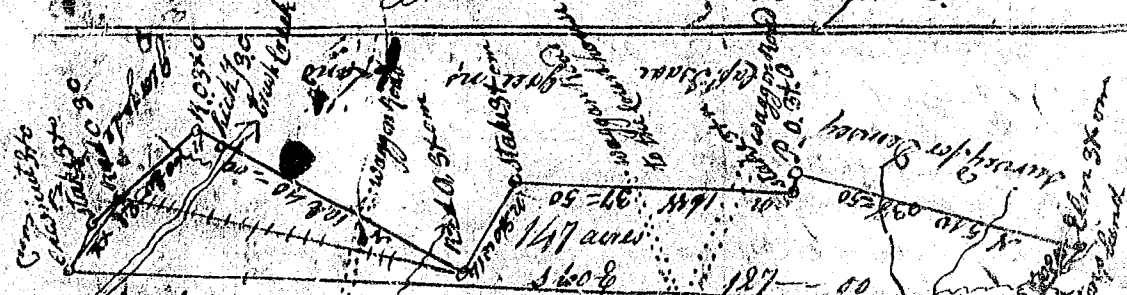

South Carolina / Pursuant to an warrant from John Thomas Esq -
Dated 15th June 1799 I have admeasured and laid out unto
Cap. Gaule green a tract of one
hundred & forty seven acres of land in greenville County N. Carolina
on branches of the St. John of Richland Creek, bounded by lines running
S.E. by Lot Abston, N.W. land survey for Demsey, N.E. by said green's
own land N.E. & N.W. by George Lewis's land, & hath such shape, form
and marks as the above plat represents, Surveyed 20th June 1799
Recorded 25th July 1799. - James Hillgore Esq.