

This plat was surveyed 27<sup>th</sup> Decr 1796  
 by J. Towns Esq. but for who is not  
 inserted, was dated 5<sup>th</sup> Aug 1796  
 Recorded 23<sup>rd</sup> July 1797

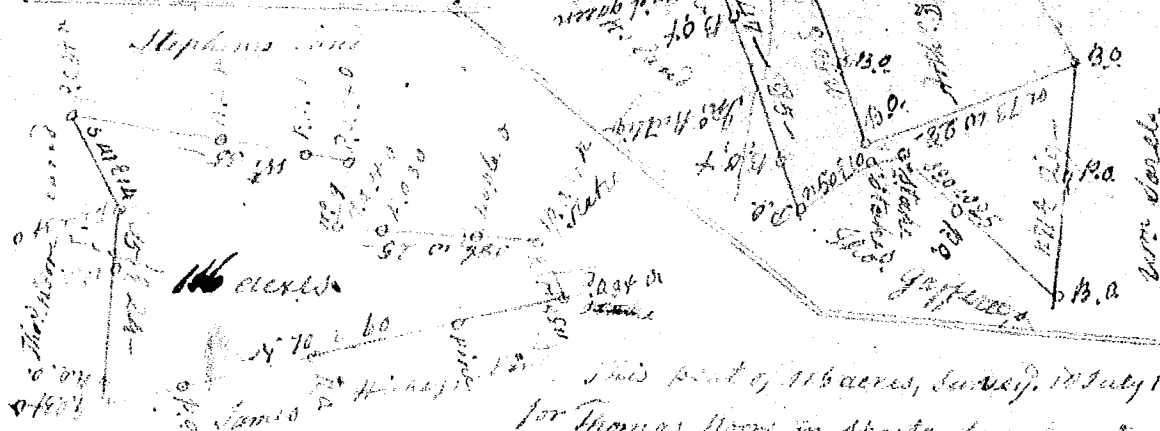

This plot of 409 acres  
 in Spartanburg County  
 on the waters of Hickety  
 Creek, bounded as per  
 Survey 16 Jan 1797  
 by Wm. Bee Dr



This plot of 65 acres was  
 Surveyed by a Warrant dated 11<sup>th</sup>  
 Decr 1796 for Christopher Gowden  
 on Backhead branch of Sugar  
 river in Spartanburg County bounded  
 as per Plat  
 20 March 1797

Recorded  
 Jan 1798  
 Jonathan Towns Esq

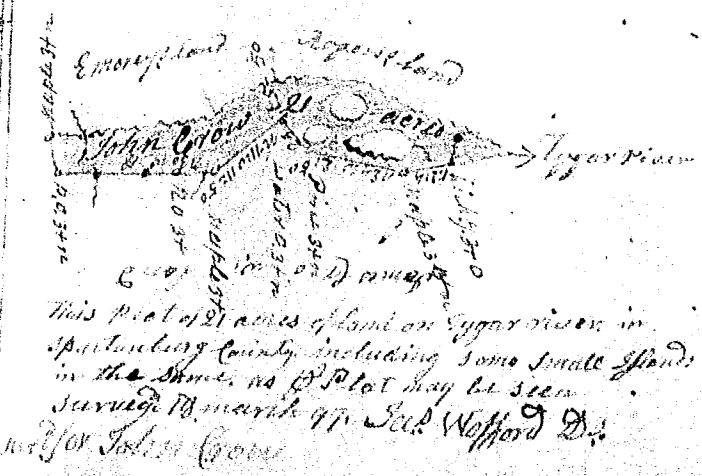

This plot of 521 acres of land on Sugar river in  
 Spartanburg County including some small islands  
 in the same as per Plat may be seen  
 Surveyed by Warrant 17<sup>th</sup> Feb Wofford Esq  
 and for John Gowden