

This plot of 361 acres part in Union (220)  
 and part in Spartanburg Counties on  
 Sugar Creek was surveyed 11 July 1795  
 for Isaac Bogan and Thompson

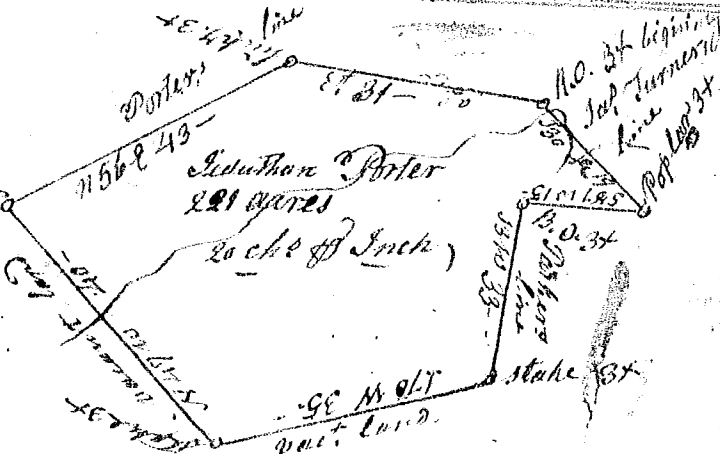

This Plot of 221 acres was surveyed for  
 Seduthan Porter in Pinkney District on  
 the waters of Gregory Creek, as pt. Plat.  
 Survey. 20 Oct. 1795. Charles Sims Sr.

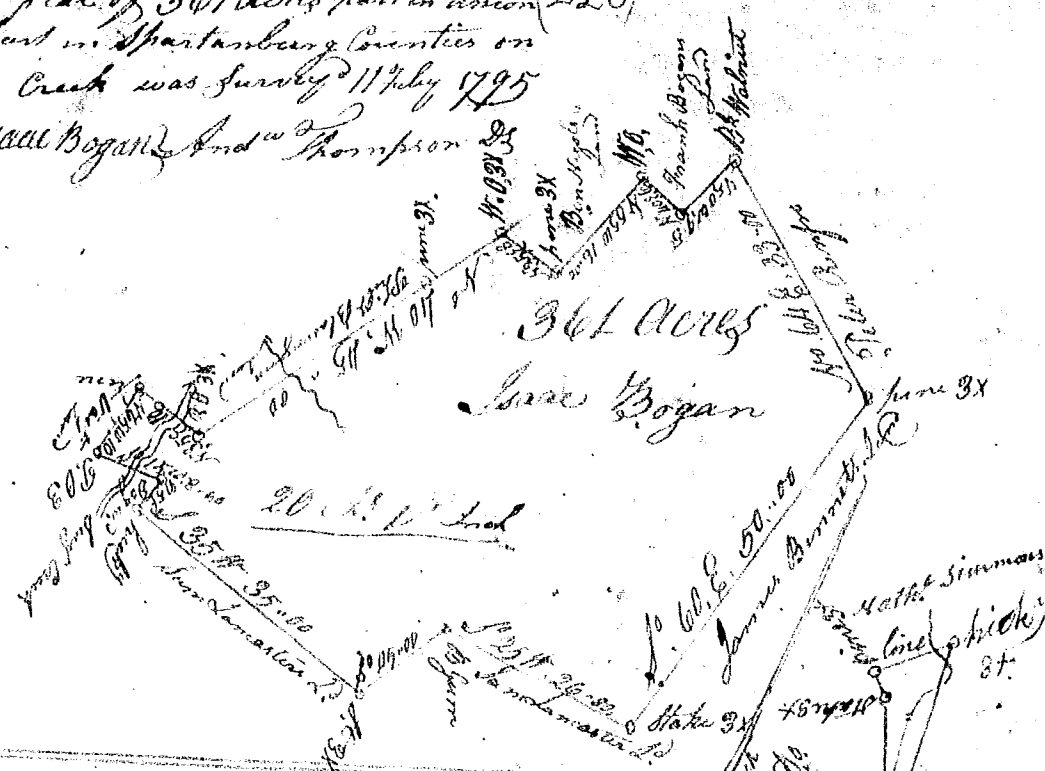
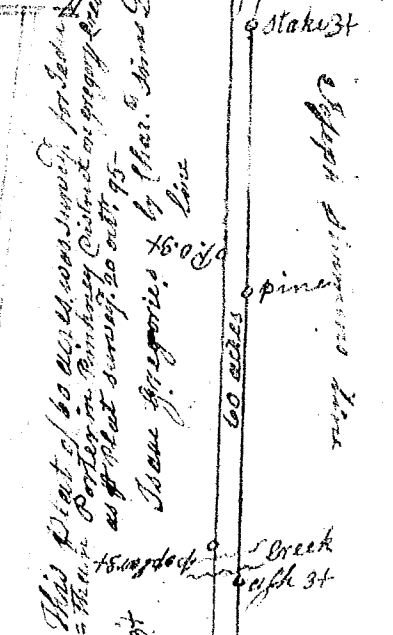

This Plot of 60 acres was surveyed for Isaac Bogan  
 in Pinkney District on Gregory Creek  
 as pt. Plat. Survey. 20 Oct. 1795.  
 Charles Sims Sr.

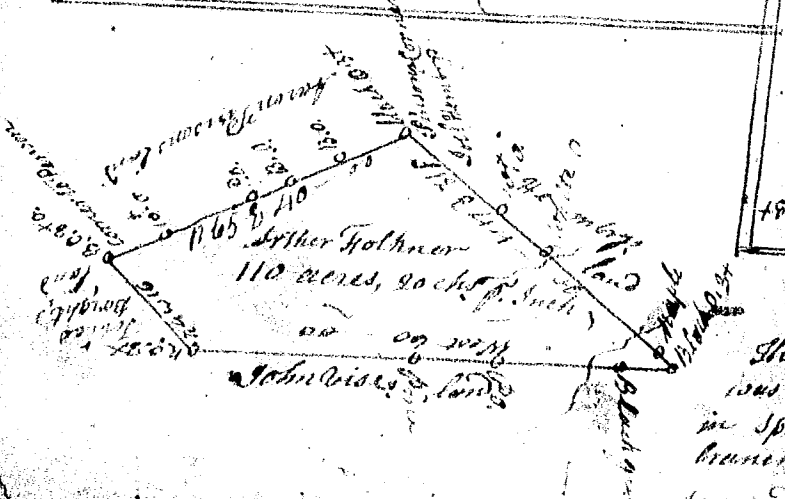

This plot of 221 acres of land  
 was surveyed for Arthur Holkner  
 in Spartanburg County on small  
 branches of Pine Creek of Tyger river  
 Survey. 2. Dec. 1794.  
 Andrew Morrison Jr.