

South Carolina Pursuant to a warrant from John Thomas, Comr. of locs. & side Saluda, I have admeasured and laid out unto Patrick Cunningham a tract of 200 acres of land, in Laurens County on the waters of Cain Creek, and hath such shape and marks as the annexed plat doth represent. Certified the 15th July 1794 - Pat. Cunningham Ds.

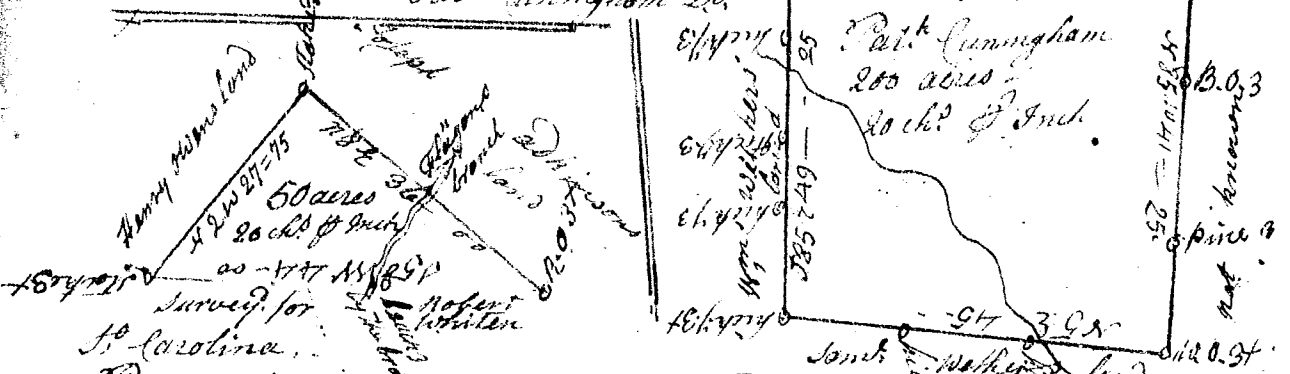

Pursuant to a warrant from John Thomas Esq. Comr. of locs. & side Saluda dated 27 July 1795. I have admeasured and laid out unto Henry Owens a tract of fifty acres of land in Laurens County on Flanagans branch of Duncans Creek, of more bounded by a line running N. 88 E by Joseph Atchson's land a bounty survey for one Dickey 150 w by A. S. Whitten N. 24. by Henry Owens, and hath such shape and marks, as the above Plat Represents. Survey 10 Aug. 1795. A. Pearson Ds.

South Carolina Pursuant to a warrant from John Thomas, Comr. of locs. & side Saluda dated 16, Jan. 1797. I have admeasured & laid out to Elijah King a tract of 198 acres of land in 96 District bounded on a branch of Buffalo Creek bounded N. & E. by land survey for one Cloney W. by land survey for the said King all other sides supposed vacant and hath such shape and marks as the above plat Represents. Survey 15th Aug. 1796. Wm. Wright Ds.

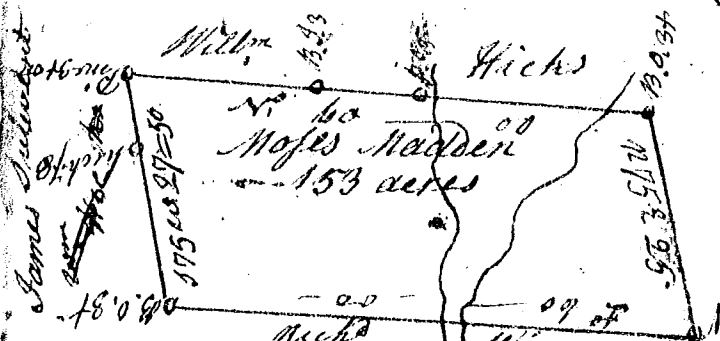
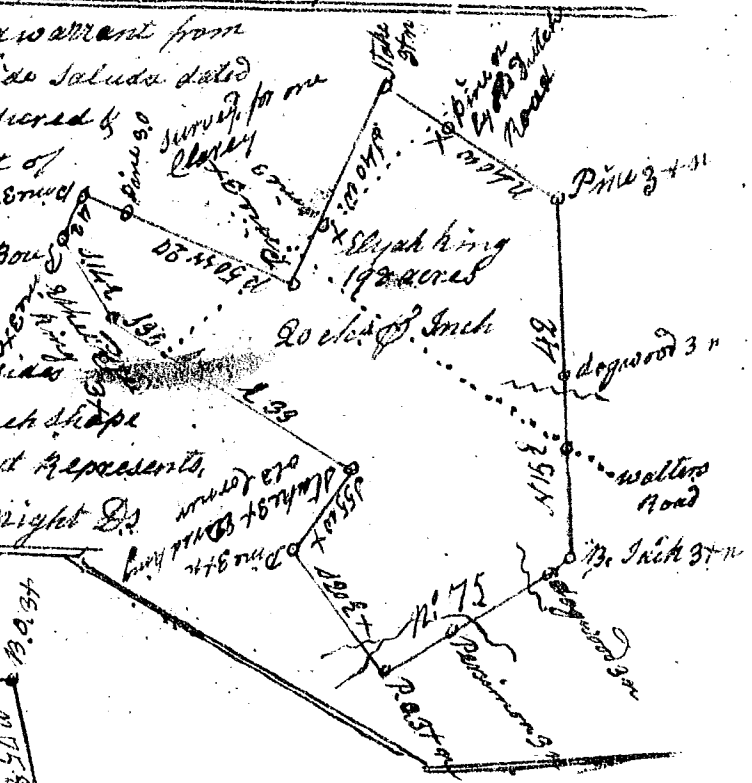

This plat was surveyed for Moses Madden by warrant dated 2^d Sept. 1794, and Survey 3 Sept. 1794, by recorded 13th Oct. 94 } John Rodgers Ds.