

South Carolina. Pursuant to a warrant from John Thomas Landlord dated 16<sup>th</sup> March 1793 I have measured and laid out unto Walter Mathews a tract of 405 acres of land in Laurens County on a branch of Duddy Creek called Williams branch, bounded on the N<sup>W</sup> by Williams S. Ambrose Huggins & on the N<sup>E</sup> by Mr. Hunter & on Oliver Mathews, and hath such shape and marks as the above plat represents surveyed to me 6<sup>th</sup> March 1795. Jonathan Downs D.S.

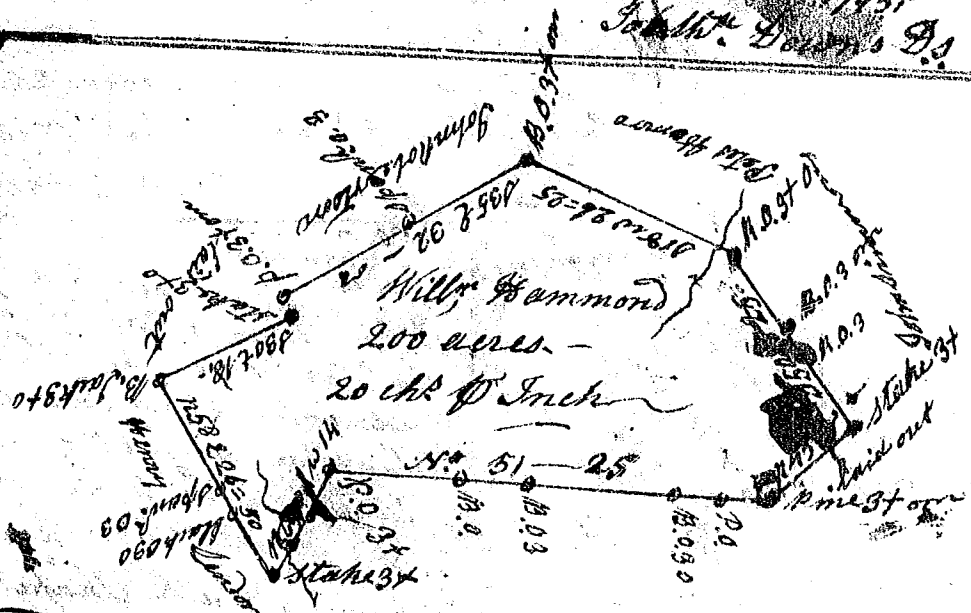

The warrant of this plot is dated 14<sup>th</sup> May 96 and surveyed 20<sup>th</sup> May 96 for William Hammond 200 acres by Jonathan Downs, D.S.