

all shown by a scale of 20 paces to an inch

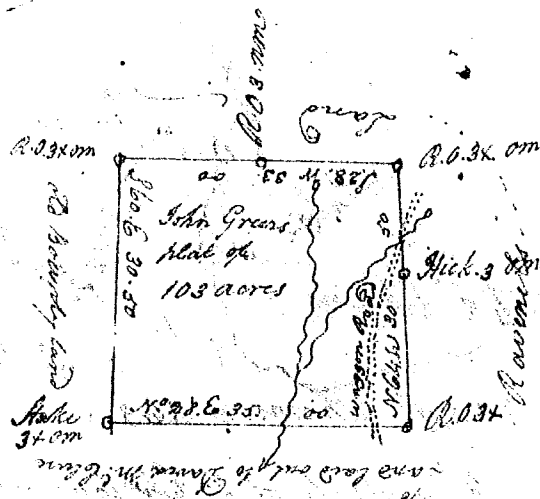

State of S^c Carolina

Pursuant to a warrant from John Thomas Esq^r Com^r of Locations N^o Saluda dated the 18th of July 1793. I have admeasured & laid out unto John Green a Tract of one hundred & three acres of land in Laurens County on a small Branch of the S^c Fork of Dumars Creek bounded by lines running N & S. W. by Ravensland N & E by land laid out to David M. Clune and S. E. by Old Bounty land the owner unknown and hath such shape & marks as the above plat Represents
 Surveyed the 19th of July 1793 James Kelgore D.S.

S^c Carolina

Pursuant to a warrant from John Thomas Esq^r Com^r of Locations N^o Saluda. I have admeasured and laid out unto Patrick Cunningham & Jacob Bowman a tract of one hundred and Sixty acres of land in Laurens County on the west side of Reddy River bounding to the S^c on Patrick Cunningham and Jacob Bowmans land to the westward on Michael Box's land & part on W^m Tennants land to the

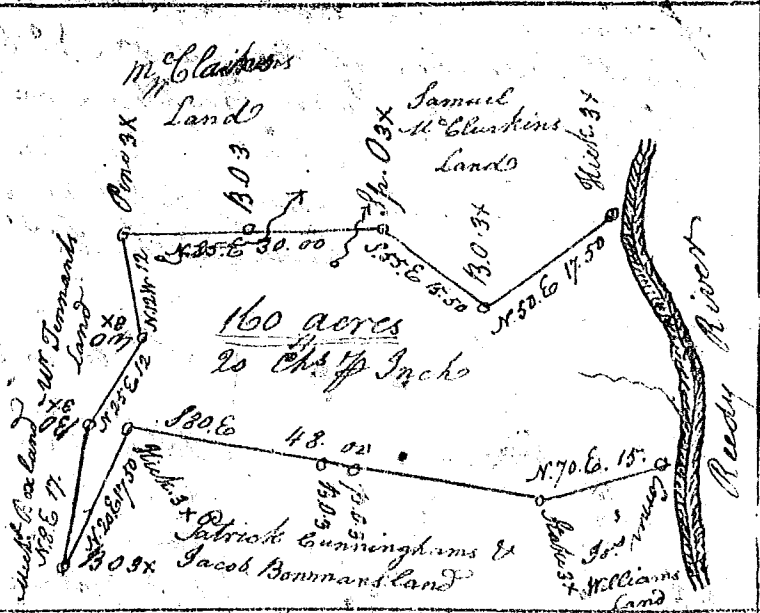

N^o part on M^cClair's, and part on Samuel M^cClair's land, and hath such shape and marks as the above plat Represents
 Surveyed the Sixth day of January 1794

Patrick Cunningham D.S.