

State of S<sup>o</sup> Carolina

Pursuant to a warrant from John Thomas Esq. Com<sup>r</sup> of Locations N<sup>o</sup> Saluda, dated the Eleventh day of July 1793 I have admeasured and laid out unto Larkin Lancaster a tract of two Hundred & twelve acres of Land in Spartanburg County on the North Side of Dutchmans Creek of Tygar River, Bounded Eastwardly & Northwardly by James Bennetts Land Northwardly & Westerly by Sam. Lancasters Land, Westwardly and Eastwardly by Thomas Evatts Land, Westwardly & Southwardly By W<sup>m</sup> Bratchers Land, all other sides by Vacant Land and hath such Shape and marks as the above plat Represents

Surveyed the 13<sup>th</sup> day of July 1793. Sam Lancaster Ds

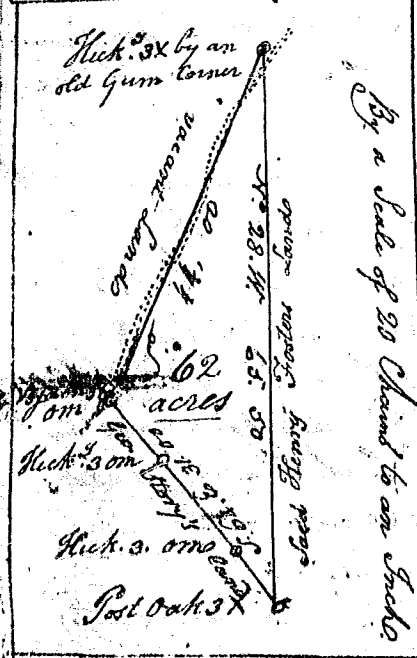

S<sup>o</sup> Carolina

Pursuant to a warrant from John Thomas Com<sup>r</sup> of Locations dated the 20<sup>th</sup> day of Sept<sup>r</sup> 1793. I have admeasured & laid out unto Henry Foster a tract of sixty two acres of Land in Pineknief District Union County and on the North Side of Fairforest Creek Bounded on the S.W. by S. Henry Fosters Land, on the N<sup>o</sup> by George Storrs Land and on the East by Vacant Land. It hath such Shape and marks as the above plat Represents.

Surveyed the 21<sup>st</sup> day of Sept<sup>r</sup> 1793

John Cornell Ds