

By scale 20 chains to an inch.

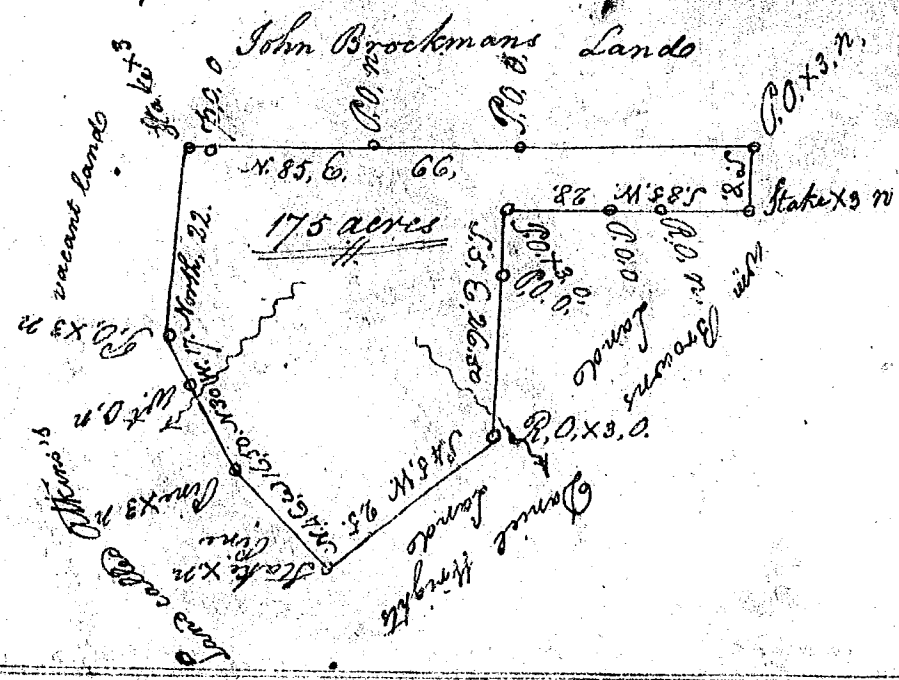

State of S^o Carolina

Pursuant to a warrant from John Thomas Com^o of Locations in Ninety six district No 1 of Saluda dated the 4th day of August 1791. I have admeasured and laid out unto Daniel Wright a tract of One hundred and seventy five acres situate in said District lying on the Branches of Derbers Creek the waters of Enoree River; Running N.E. with John Brockmans Land & S.W. and S.E. by William Boens land and S.W. with Daniel Wrights. and N.W. by land called Athens all other sides by vacant land and hath such Shape and marks as the above plat Represents. Surveyed the 16th day of August 1791

James Wofford D.S.



S^o Carolina } Pursuant to a
Lawrens County } warrant from John
Thomas Esq. Com^o of Locations No
Saluda dated this 5th day of Nov. 1792
I have admeasured & laid out unto
William Crisp a Tract of One hun-
dred & forty four acres of Land in
County on the Branches of the Beaver
Creek of Darris's Creek bounding
S. Richambaco & Tho^s Ship E. on
Copeland N. on division with
and hath such Shape & marks as
the above plat Represents
Surveyed the 7th Nov. 1792 John Rodgers