

State of S<sup>c</sup> Carolina

Pursuant to a warrant from John Thomas Esq<sup>r</sup> Com<sup>r</sup> of Locations dated the 12<sup>th</sup> Jan. 1779. I have ad-measured and laid out unto James Sulpot (Heir at law to Edw. Sulpot) a Tract of 200 acres of Land in Laurens County on a Branch of Rayburns Creek Called Reeds Branch Bounded as the above plat Represents.

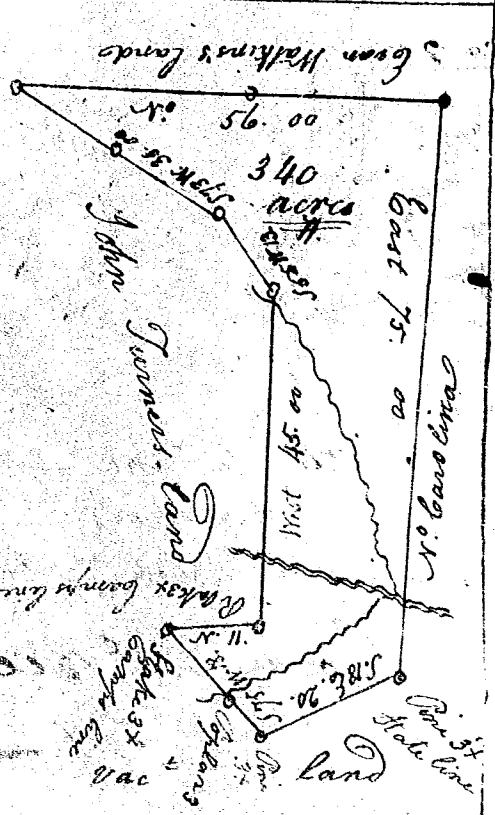

S<sup>c</sup> Carolina South<sup>th</sup> Down<sup>s</sup> Is

Pursuant to a warrant from John Thomas Esq<sup>r</sup> Com<sup>r</sup> of Loc<sup>s</sup> No<sup>14</sup> Saluda dated the 18<sup>th</sup> Sept. 1774 I have ad-measured & laid out unto Thomas Thomson a tract of 340 acres of land in Spartanburg Co. on Ashworths Creek joining the N<sup>o</sup> Carolina line and hath such shape and marks as the above plat Represents.

Surveyed the 23<sup>rd</sup> Sept. 1774

Vardry M<sup>r</sup> Bee  
Is