

By a Plat of 20 acres
No. 17 in Book 12

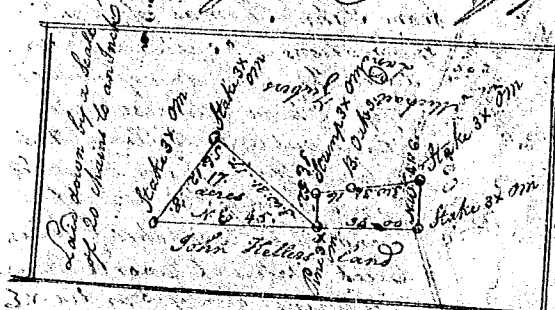

S. Carolina

Pursuant to a warrant from John Thomas Esq.
Comr of Locations No. 3 of the River dated the 18th day of July
1792. I have admeasured & laid out unto Samuel Norate
a tract of Ninety six acres of Land in the said district Situate
and Lying on Springers Creek, Waters of Enoree River, Runnin-
g N. with Benjamin Norwood's Land N.W. & S.W. with John Hallett's
Land N.E. with Edward Arnold's Land & N.E. with old lines &
hath such shape & marks as the above plat Represents—
Surveyed the 19th day of July 1792 James Doughty



Pursuant to a warrant Granted by John Thomas
Comr of Locations bearing date the 18th of August
1792. I have admeasured and laid out unto James
Dougharty a plantation or tract of Land contain-
ing seventeen acres being and Lying in Ninety Six
district Bounded on the N. & E. by John Hallett's
Land on the N. & W. by Michael Tubers Land and
hath such marks shape Buttings & Boundings as
the above plat Represents—
Surveyed this 13th day of August 1792
James Doughty

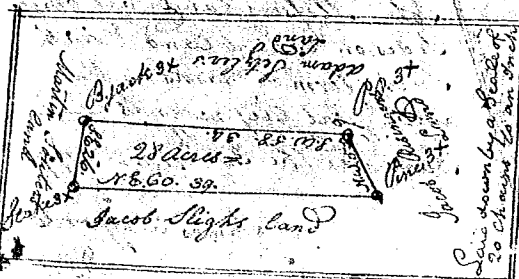

Pursuant to a warrant Granted by John Thomas
Esq. Comr of Locations bearing date August the
10th 1792. I have admeasured and laid out unto
James Dougharty a plantation or tract of
Land containing twenty eight acres being
and Lying in Ninety Six District bounded
by Martin Setzlers Land on the west, by Jacob
Risingers Land on the South, by Adam Setzlers
Land on the North and hath such shape
Marks Buttings and Boundings as the above plat Represents—
Surveyed the 14th day of August 1792
James Dougharty