

60

Run down by a State of 20 chains
to an old field.

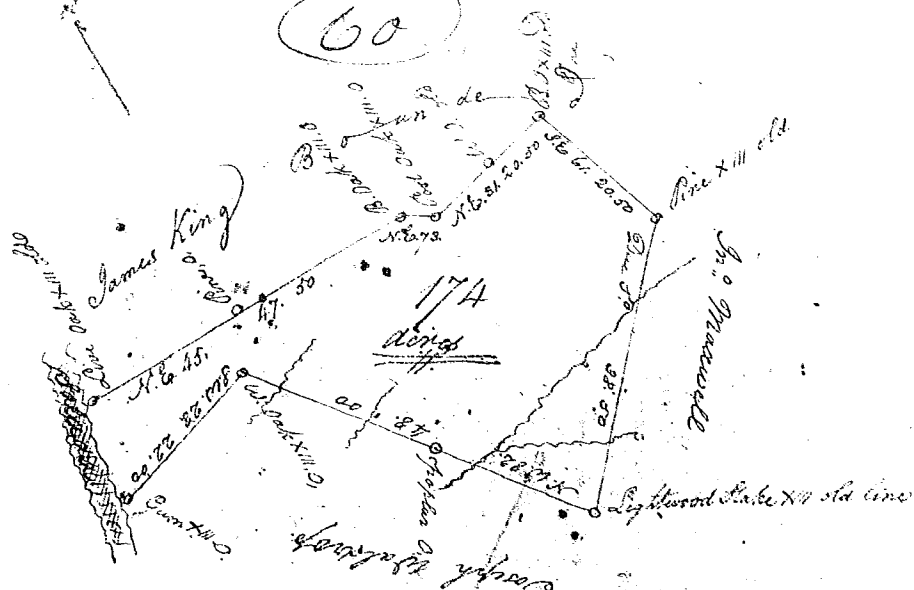

S. Carolina

Pursuant to a Warrant from John Thomas Esq. Com^r of Locations N^o Saluda River dated the 28th February 1792. I have measured & laid out unto Luke Waldrop a plantation or tract of Land containing One hundred & Seventy four acres situated along and being in Laurens County on Saluda River, Bounded by a line running N. 65. 30. by land belonging to Jas King, by a line due South by land belonging to J^o. Maxwell, by a line running N. 45. 30. by land belonging to Joseph Waldrop: all other sides by old ~~surveys~~ surveys and hath such shape form & marks as the above plat Represents —
Surveyed the 21st day of April 1792

State S. Carolina

Pursuant to a warrant from John Thomas Com^r of Locations N^o Saluda I have measured and laid out unto John Smith (as Soldier's Bounty) a tract of two hundred acres of land in York County Pinckney district on the waters of Broad River on a branch called the Long Branch Bounded N^o by land of Tho^s Logan and John M^c. Lee and and W^m Copeland, & W^d by lands of Francis Adams, & on other sides by vacant land and hath such shape form and marks as the above plat Represents.
Surveyed the 30th July 1792

Vardry M. bee
D.S.

