

State of S. Carolina

Pursuant to a warrant from John Thomas Esq. Com. of Locations N. Saluda bearing date the 3<sup>rd</sup> May 1792. I have admeasured and laid out unto John Cohen a tract of Seventy three acres of Land in Laurens County on the Branches of Derbins Creek of Enoree River Bounding by a line Running S.W. on Wm. Bowens Land N.W. & N.E. on Land unknown By a line Running S.E. on Jesse Wallaces Land & hath such form and marks as the above plat Represents Surveyed the 7<sup>th</sup> day of May 1792

B. Arnold D.S.

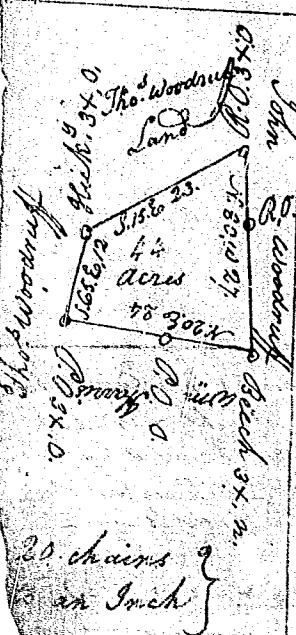

State S. Carolina

Pursuant to a warrant from John Thomas Esq. Com. of Locations in Ninety six N. Saluda, dated the 27<sup>th</sup> day of February 1792. I have admeasured and laid out unto Thomas Woodruff a tract of forty four acres of Land in Said District Situated lying on the Branches of Ferguson's Creek, the waters of Tigger River Running S.E. with Tho. Woodruffs Land S.W. with John Woodruffs Land N.E. with Richard Harris's Land and hath such Shape and marks as the above plat Represents.

Surveyed the 21<sup>st</sup> day of Feb. 1792. James Wofford D.S.