

South Carolina
 Pursuant to a warrant from John Thomas Esq. Com. of Locations dated the 16th January 1792 I have admeasured and laid out unto George Whitmore a tract of One hundred and twenty four acres of Land situate in Laurens County & Ninety Six District on two small drafts of Duncan Creek waters of Enoree River Bounded by lines Running N. 68^o 44' N. E. by Land held by Henry Davis, by lines Running S. 68^o 44' N. E. by Land Surveyed for Andrew & Matthew M. Croy, by a line Running S. E. by John Watson, all other lines by Land Surveyed for George Whitmore, and with such Shape and marks as the above plat Represents.
 Surveyed the 17th January 1792

A. Pearson D.

South Carolina
 Pursuant to a warrant from John Thomas Esq. Com. of Locations N. S. Saluda, dated the 16th January 1792 I have admeasured and laid out unto George Whitmore a tract of land containing fifty four acres situate in the district of Ninety Six on Duncan's Creek a draft of Enoree River Bounded by lines Running S. 48^o 44' N. E. & S. 21^o W by Land Surveyed for James Duncan, by a line Running N. 68^o W by In. Bouland's land by a line Running N. 68^o W by Bryce Prathers land, all other lines by Land Surveyed for Reuben Flanigan and with such Shape & Marks as the above plat Represents.

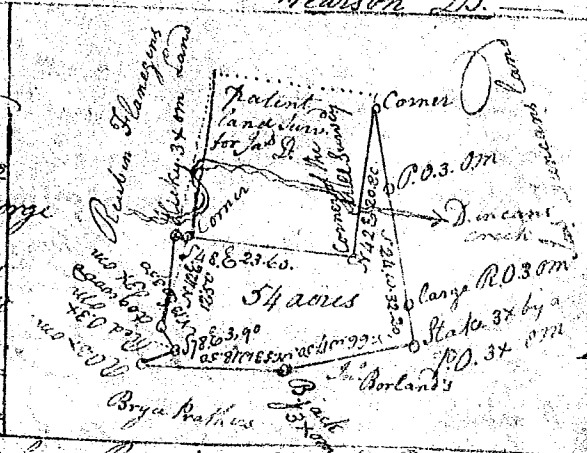

Surveyed the 27th January 1792 A. Pearson D.