

Scale of 20 Chains to an Inch

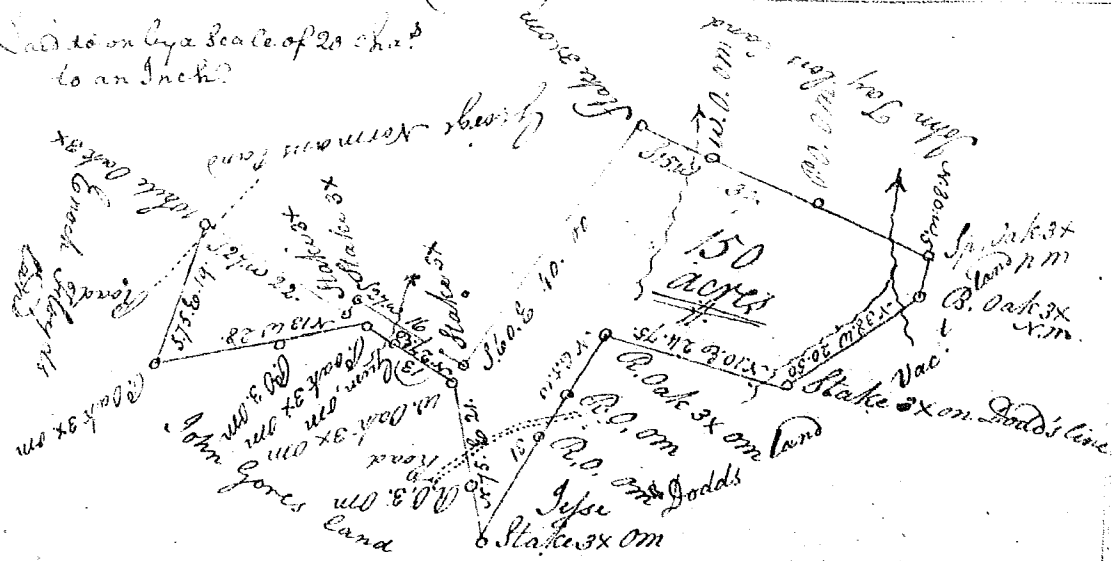

State of S. Carolina

Pursuant to a warrant from John Thomas Esq. Com<sup>r</sup> of Locations N. Saluda. Dated the 16<sup>th</sup> March 1792. I have admeasured and laid out unto John Taylor a tract of one hundred and fifty acres of Land on the waters of Johns Creek a branch of Enorce River in Williams County. Bounded by lines running S. W. & N. E. on George Morris and John Taylors Land N. W. & N. E. on vacant & on Jesse Dodds and John Gores Land, and hath such shape marks &c. as the above plat Represents

Surveyed the 16<sup>th</sup> day of March 1792

Robert Hanna Dep. Surv.

State of S. Carolina

Pursuant to a warrant from John Thomas Esq. Com<sup>r</sup> of Locations N. Saluda dated the 16<sup>th</sup> March 1792. I have admeasured and laid out unto John Taylor a tract of fifteen & an half acres of land on the waters of Johns Creek a branch of Enorce River. Bounded by a line running S. 62. W. on John Taylors Land N. 20. E. on Ephraim Smiths Land N. 62. W. on James Jacksons Land and S. 15. W. on said Taylors Land and hath such shape and marks as the above plat Represents.

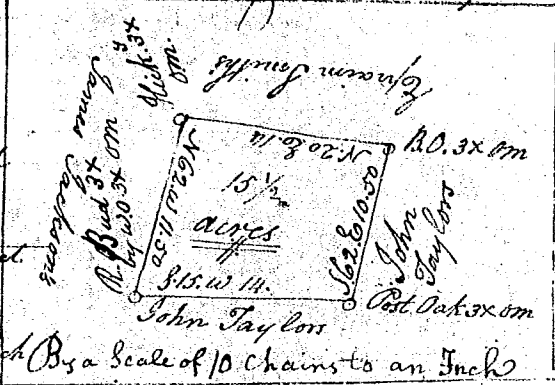

Surveyed the 16<sup>th</sup> March 1792

Robert Hanna D.S.