

S. Carolina Pursuant to a warrant from John Thomas Esq. Com.  
 96 District of Locations N. Saluda River dated the 8<sup>th</sup> June 1790  
 I have admeasured and laid out unto James Gamble a tract of fifty nine  
 acres of land on the waters of Duncans Creek in Laurens County, having  
 such Shape Marks Buttings and Boundings as the above plat Represents  
 Surveyed the 27<sup>th</sup> June 1791  
 William Hunter Esq.

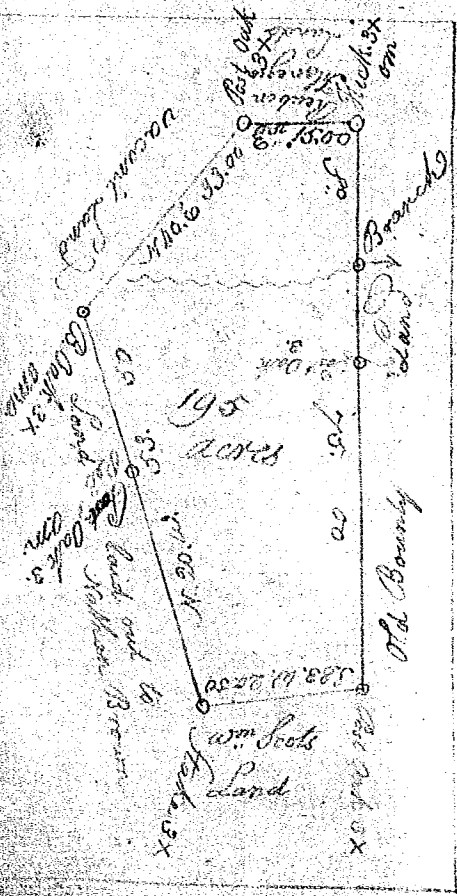

S. Carolina Pursuant to a warrant  
 from John Thomas Esq. Com. of Locations  
 No Salary, I have admeasured and laid  
 out unto Henry Owens a Tract of One  
 hundred & ninety five acres of Land  
 on a Small Branch of Duncans Creek  
 in Laurens County, having such shape  
 marks Buttings & Boundings as the  
 above plat Represents.  
 Surveyed the 12<sup>th</sup> Nov<sup>r</sup> 1791  
 Robert Thomas  
 Dep. Surveyor