

South Carolina Pursuant to warrant (453)

Comd. of lock, N side Saluda Dated 28<sup>th</sup> July 1798. I have admeasured and laid out unto Caleb Fawcett a tract of Sixty six acres of land in Pinkney District in Union County on branches of Cain Creek waters of Tugal River bounded by lines running N.E. & S.E. by land survey for Abraham Holingsworth and James Hawkins, N.W. by land surveyed for Elizabeth Brown, S.W. by vacant land S.E. & W. by land survey for Joseph Holingsworth and Amey Holingsworth, and hath such shape & marks as the above plat represents -  
Survey 9<sup>th</sup> Augt 1798. J. P. Senter Ds  
Recorded 25<sup>th</sup> Oct<sup>r</sup> 1798,

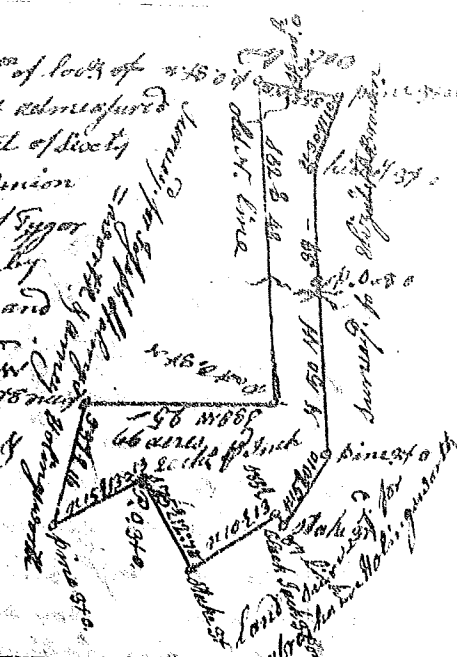

South Carolina Pursuant to warrant from John Thomas, Comd. of lock, N side Saluda Dated 17<sup>th</sup> Augt 1798, I have admeasured and laid out unto James Ashby a soldier of this Continent one hundred acres of land in Union County on branches of Cain Creek waters of Tugal river, bounded by lines running N.W. & S.W. by James Hawkins and Charles Sims, N.E. & S.E. by land survey for Benjamin Hawkins, and hath such shape as the above plat represents.

Survey 15<sup>th</sup> Sept<sup>r</sup> 1798. J. P. Senter Ds  
Recorded 25<sup>th</sup> Oct<sup>r</sup> 1798



State of S<sup>c</sup> Carolina Pursuant to a warrant from John Thomas, Comd. of lock, North Side Saluda dated 26<sup>th</sup> Oct<sup>r</sup> 1798. I have admeasured and laid out unto John Rofs a tract of fifty two acres of land including part of said John Rofs improvement his House &c. on branches of Enoree river in Greenville County bounding by lines running N.E. by land granted to Isaac Morgan N.W. by land granted to George Rofs S.E. and S.W. by land survey for Joseph M. Goughlin & S.E. by John Rofs land, and hath such form & marks as the above plat represents, -  
Survey 27<sup>th</sup> Oct<sup>r</sup> 1798. W. D. Thomas, Ds  
Recorded 29<sup>th</sup> Oct<sup>r</sup> 1798,

John Rofs land  
52 acres  
20 ch<sup>l</sup> of buck  
N 10 W 50  
granted to Geo<sup>d</sup> Rofs  
P. Rofs  
J. M. Goughlin  
land  
Ned oak 94 on  
land

