

393
 South Carolina Pursuant to a warrant
 from John Thomas Esq. Comr. of locⁿ N. side
 Saluda dated 20 December 1796. I have
 admeasured & laid out unto Benjamin
 Maglin a tract of seventy six acres of
 land in Washington District & Greenville
 County on a branch of
 Saunders Creek of Needy river -
 bounded W. by said Maglin and Lang-
 stars land, S. by Solomon West's land & by John West's land N.E. by
 vacant land, and hath such form and marks as the above plat
 represents.

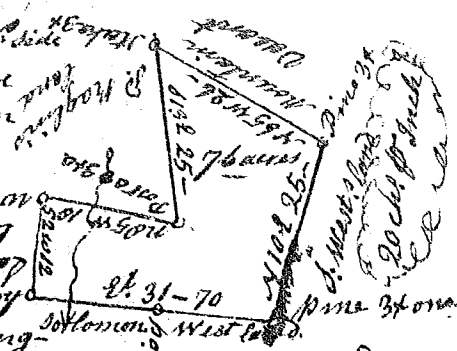

Surveyed 25th Jan^y. 1797 John Young Sur^r. D^y.
 Recorded 10th Feb^r. 1797

South Carolina Pursuant to a warrant
 from John Thomas Esq. Comr. of locⁿ
 dated 18th Jan^y. 1797. I have
 admeasured & laid out unto
 William Griffin Turner, a tract
 of one hundred & ten acres of
 land. Situated in Greenville
 County on both sides of a small
 branch of Saluda. Bounded
 Nwardly on land Bal for Enoch Hooper
 Swardly on land laid out for person unknown
 Nwardly on land laid out for Nicholas Arnold & Nwardly on land
 laid out for Doct. Stearns. & hath such form & marks as the above
 plat represents. Surveyed the 24th day of January 1797.
 Recorded the 18th day of Feb^r. 1797. George Salmon D^y.

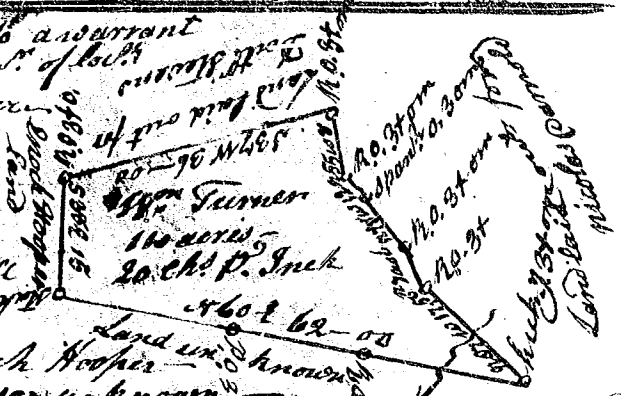

State of South Carolina Pursuant to a
 warrant from John Thomas Esq. Comr.
 of locations dated 16th Feb^r. 1797. I
 have admeasured and laid out
 unto Edwin Bain a tract of
 seventy acres of land in Greenville
 County on both sides of Big Fall
 Creek waters of the N. fork of Saluda river
 bounded N. on land laid out for Randolph Carey
 all other sides on vacant land, and hath
 such shape &
 marks as the above plat represents.



Surveyed 16th Feb^r. 1797. George Salmon D^y.
 Recorded 19th Feb^r. 1797.